

### Outline Dimensions

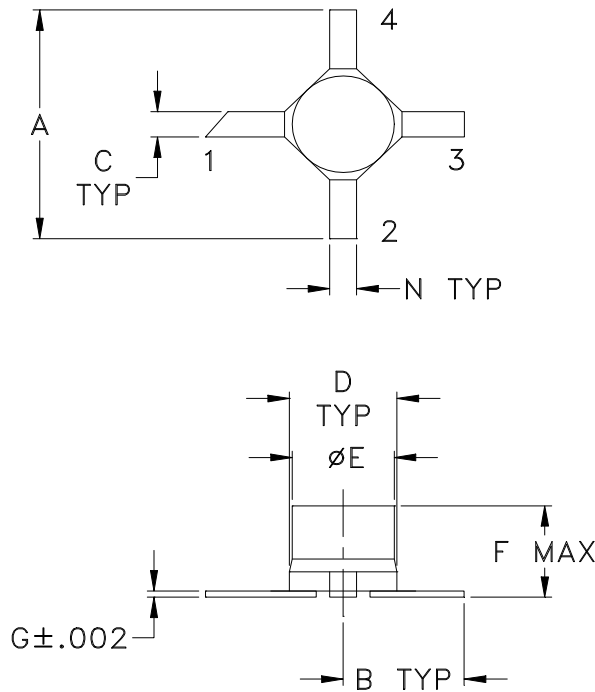

### PCB Land Pattern

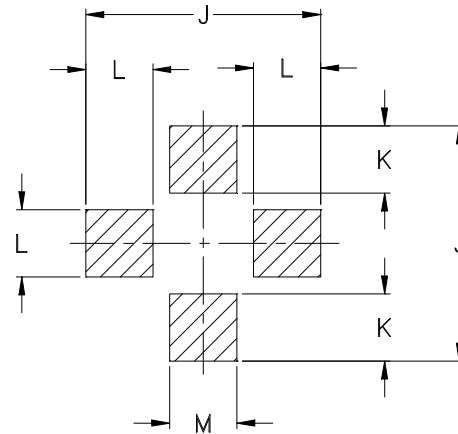

Suggested Layout,  
Tolerance to be within  $\pm .002$

CASE #	A	B	C	D	E	F	G	H	J	K	L	M	N	WT. GRAM
AF190	.180 (4.57)	.090 (2.29)	.020 (0.51)	.100 (2.54)	.083 (2.11)	.072 (1.83)	.005 (0.13)	-	.210 (5.33)	.060 (1.52)	.060 (1.52)	.060 (1.52)	.020 (0.51)	.04

Dimensions are in inches (mm). Tolerances: 2Pl.  $\pm .03$ ; 3Pl.  $\pm .015$

#### Notes:

- Case material: Ceramic.
- Termination material:  
Nickel-Iron alloy 42.
- Termination finish:  
For RoHS Case Styles: Tin-Silver alloy plate over Nickel barrier.  
For RoHS-5 Case Styles: Tin-Lead plate.
- Termination (1):  
Identified by diagonally cut lead.
- Special Tolerances: Termination width  $\pm .005$  inch, termination thickness  $\pm .002$  inch, cap diameter  $\pm .005$  inch.



INTERNET <http://www.minicircuits.com>

P.O. Box 350166, Brooklyn, New York 11235-0003 (718) 934-4500 Fax (718) 332-4661

Distribution Centers NORTH AMERICA 800-654-7949 • 417-335-5935 • Fax 417-335-5945 • EUROPE 44-1252-832600 • Fax 44-1252-837010

Mini-Circuits ISO 9001 & ISO 14001 Certified