

Outline Dimensions

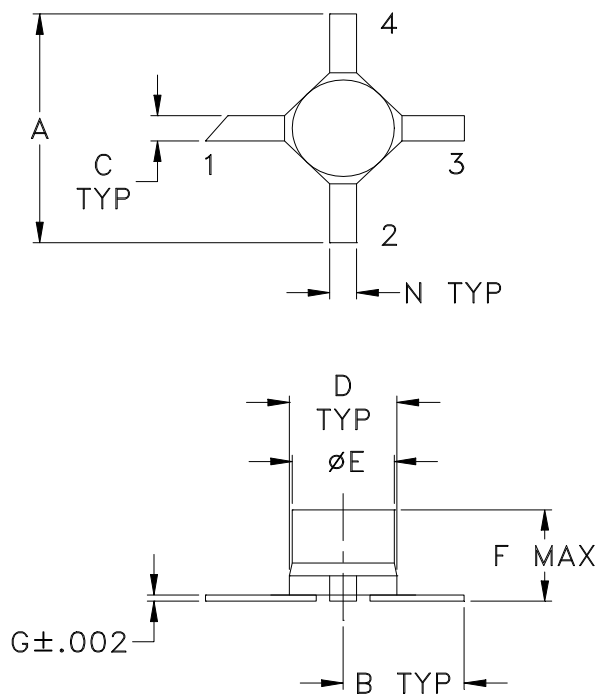

PCB Land Pattern

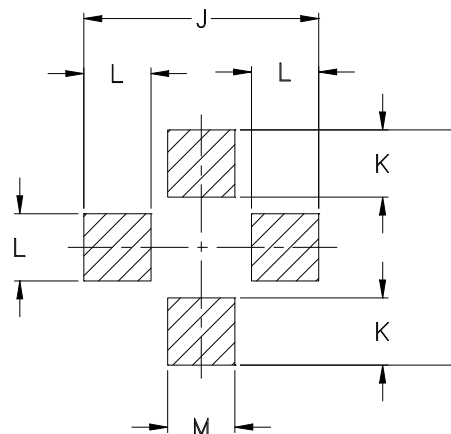

Suggested Layout,
Tolerance to be within $\pm .002$

| CASE # | A | B | C | D | E | F | G | H | J | K | L | M | N | WT. GRAM |
|--------|----------------|----------------|----------------|----------------|----------------|----------------|----------------|---|----------------|----------------|----------------|----------------|----------------|----------|
| AF320 | .200 (5.08) | .100 (2.54) | .020 (0.51) | .070 (1.78) | .068 (1.73) | .057 (1.45) | .005 (0.13) | - | .230 (5.84) | .065 (1.65) | .060 (1.52) | .080 (2.03) | .040 (1.02) | .04 |

Dimensions are in inches (mm). Tolerances: 2Pl. $\pm .03$; 3Pl. $\pm .015$

Notes:

- Case material: Ceramic.
- Termination material:
Nickel-Iron alloy 42.
- Termination finish:
For RoHS Case Styles: Tin-Silver alloy plate over Nickel barrier or Matte-Tin. (See Data Sheet)
For RoHS-5 Case Styles: Tin-Lead plate.
- Termination (1):
May have diagonal cut. Input and output interchangeable for PAT models only.
- Special Tolerances: Termination width $\pm .005$ inch, termination thickness $\pm .002$ inch, cap diameter $\pm .005$ inch.



INTERNET <http://www.minicircuits.com>

P.O. Box 350166, Brooklyn, New York 11235-0003 (718) 934-4500 Fax (718) 332-4661

Distribution Centers NORTH AMERICA 800-654-7949 • 417-335-5935 • Fax 417-335-5945 • EUROPE 44-1252-832600 • Fax 44-1252-837010

Mini-Circuits ISO 9001 & ISO 14001 Certified