

# Case Style

# BY

## Outline Dimensions

## BY1298

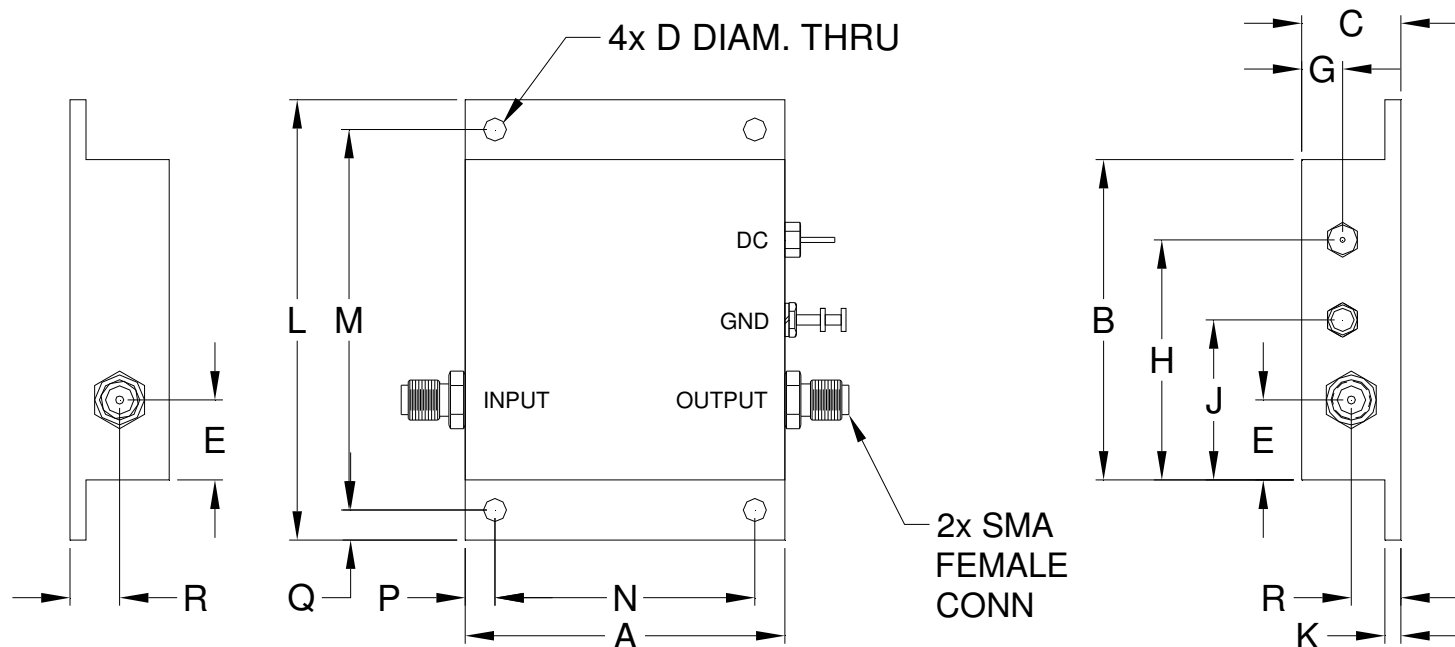

CASE#	A	B	C	D	E	F	G	H	J	K	L	M	N
BY1298	2.00 (50.80)	2.00 (50.80)	.62 (15.75)	.144 (3.66)	.50 (12.70)	- -	.26 (6.60)	1.50 (38.10)	1.00 (25.40)	.100 (2.54)	2.75 (69.85)	2.375 (60.33)	1.625 (41.28)

CASE#	P	Q	R	WT. GRAMS
BY1298	.19 (4.83)	.19 (4.83)	.31 (7.87)	71.80

Dimensions are in inches (mm). Tolerances: 2 Pl.  $\pm .03$ ; 3 Pl.  $\pm .015$

### Notes:

1. Case material: Aluminum alloy.
2. Case finish: Clear chemical conversion coating, non-chrome or trivalent chrome based.

**Mini-Circuits**<sup>®</sup>

INTERNET <http://www.minicircuits.com>

P.O. Box 350166, Brooklyn, New York 11235-0003 (718) 934-4500 Fax (718) 332-4661

Distribution Centers NORTH AMERICA 800-654-7949 • 417-335-5935 • Fax 417-335-5945 • EUROPE 44-1252-832600 • Fax 44-1252-837010

Mini-Circuits ISO 9001 & ISO 14001 Certified