

### Outline Dimensions

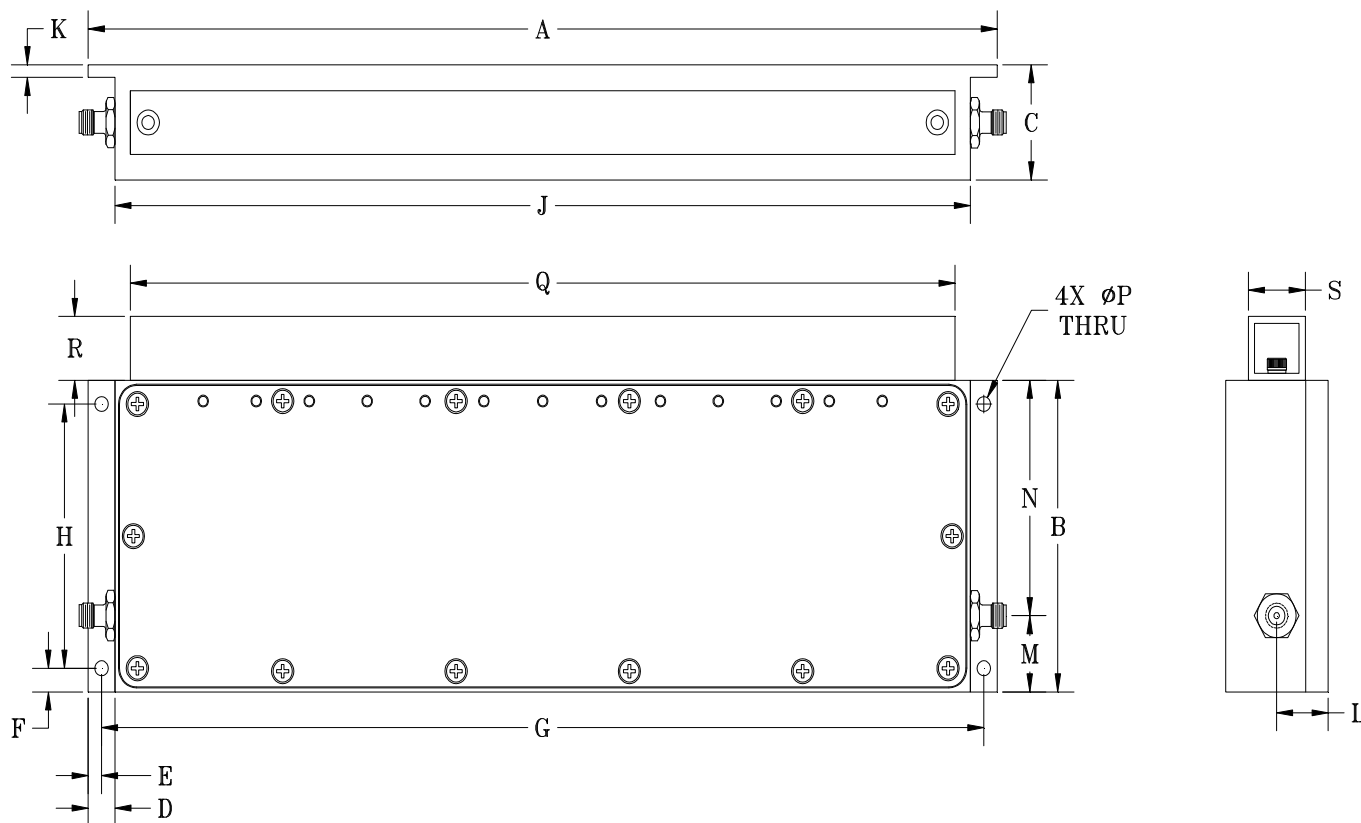

CASE #.	A	B	C	D	E	F	G	H	J	K	L	M	N	P
KT1510	10.193 (258.90)	3.110 (78.99)	1.150 (29.21)	0.300 (7.62)	0.150 (3.81)	0.236 (5.99)	9.893 (251.28)	2.637 (66.98)	9.593 (243.66)	0.127 (3.23)	0.577 (14.66)	0.761 (19.33)	2.349 (59.66)	0.150 (3.81)

CASE #.	Q	R	S	WT. GRAM
KT1510	9.250 (234.95)	0.638 (16.21)	0.638 (16.21)	845

Dimensions are in inches (mm). Tolerances: 2Pl.  $\pm .03$ ; 3Pl.  $\pm .015$

#### Notes:

- Case material: Aluminum alloy.
- Case finish:
  - Case & Cover of the unit – coated with epoxy polyester over Silver plated.
  - Tuning screw protective cover – coated with epoxy polyester over aluminium alloy.



Distribution Centers NORTH AMERICA 800-654-7949 • 417-335-5935 • Fax 417-335-5945 • EUROPE 44-1252-832600 • Fax 44-1252-837010

Mini-Circuits ISO 9001 & ISO 14001 Certified

INTERNET <http://www.minicircuits.com>

P.O. Box 350166, Brooklyn, New York 11235-0003 (718) 934-4500 Fax (718) 332-4661