

Outline Dimensions

RA2456

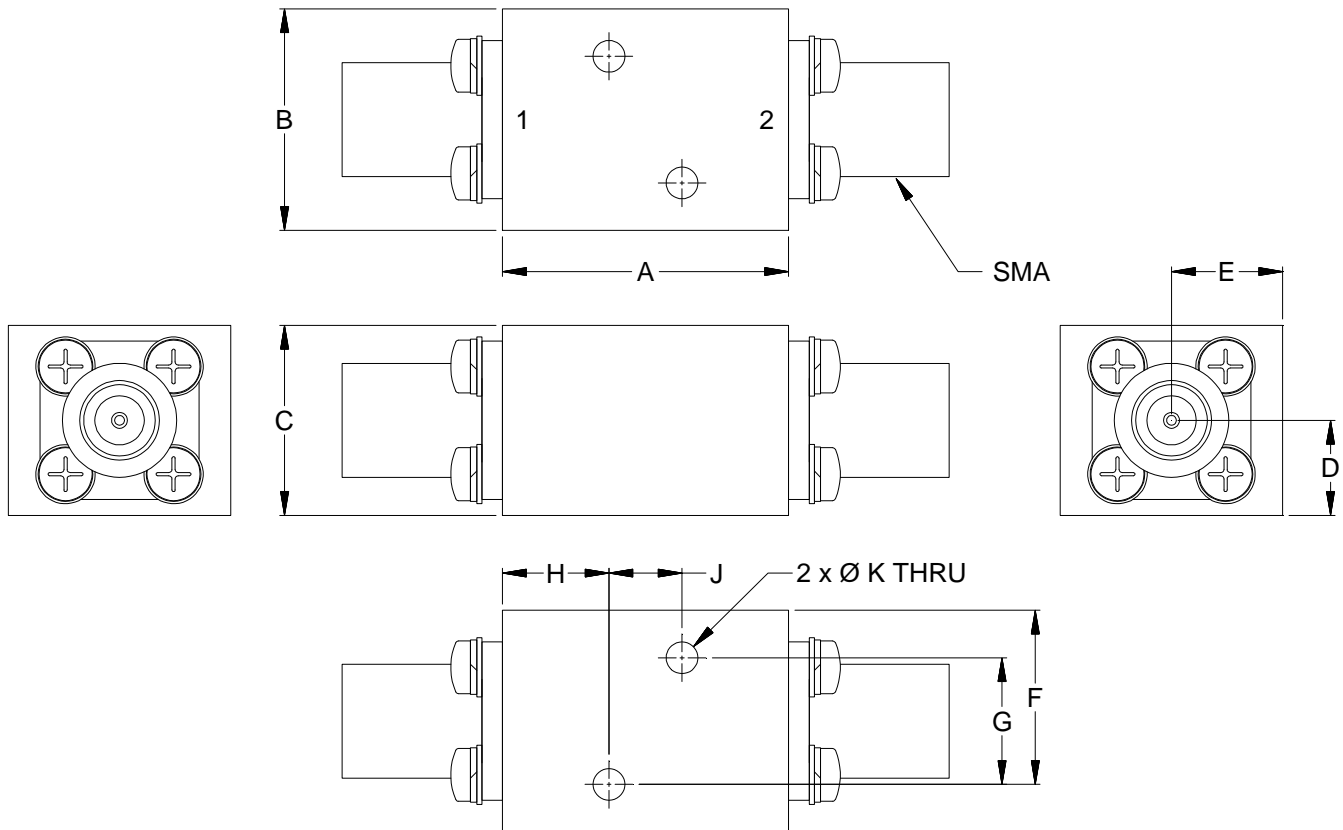

CASE#	A	B	C	D	E	F	G	H	J	K	WT.GRAMS
RA2456	.90 (22.86)	.70 (17.78)	.60 (15.24)	.30 (7.62)	.35 (8.89)	.55 (13.97)	.400 (10.16)	.34 (8.51)	.230 (5.84)	.100 (2.54)	55

Dimensions are in inches (mm). Tolerances: 2 Pl. $\pm .05$; 3 Pl. $\pm .015$

Notes:

1. Case material: Brass.
2. Case finish: Powder coated over silver plating
3. Refer to the individual model data sheet for the type of connectors available.



P.O. Box 350166, Brooklyn, New York 11235-0003 (718) 934-4500 Fax (718) 332-4661 For detailed performance specs & shopping online see Mini-Circuits web site



The Design Engineers Search Engine Provides ACTUAL Data Instantly From MINI-CIRCUITS At: www.minicircuits.com

RF/IF MICROWAVE COMPONENTS