

Case Style

UH

Outline Dimensions

UH2851

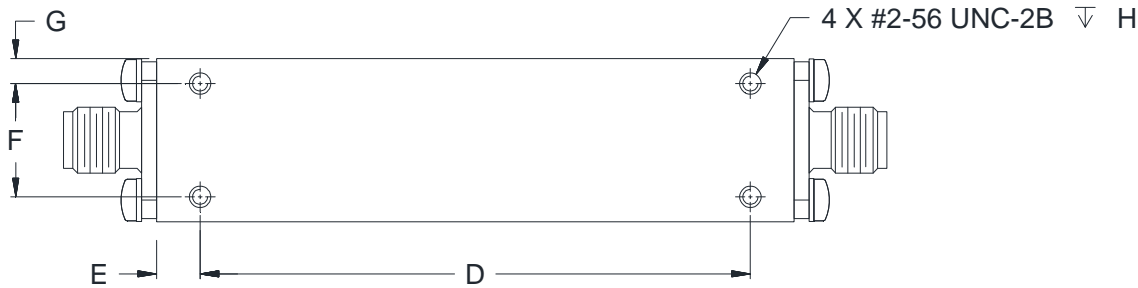
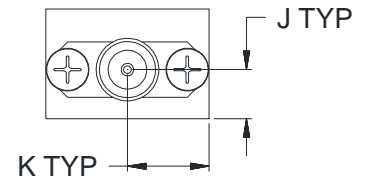
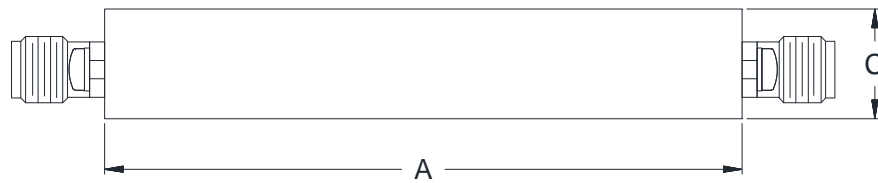

CASE#	A	B	C	D	E	F
UH2851	2.56 (65.0)	.66 (16.6)	.44 (11.2)	2.209 (56.11)	.18 (4.4)	.455 (11.56)

CASE#	G	H	J	K	WT. GRAMS
UH2851	.10 (2.5)	.100 (2.54)	.20 (5.0)	.33 (8.3)	68

Dimensions are in inches (mm). Tolerances: 2 Pl. $\pm .100$; 3 Pl. $\pm .015$

Notes:

1. Case material: Brass and Aluminum alloy.
2. Case Finish: Powder coated.
3. Refer to the individual model data sheet for the type of connectors available.



P.O. Box 350166, Brooklyn, New York 11235-0003 (718) 934-4500 Fax (718) 332-4661 For detailed performance specs & shopping online see Mini-Circuits web site



The Design Engineers Search Engine Provides ACTUAL Data Instantly From MINI-CIRCUITS At: www.minicircuits.com

RF/IF MICROWAVE COMPONENTS