

## Outline Dimensions

UY3145

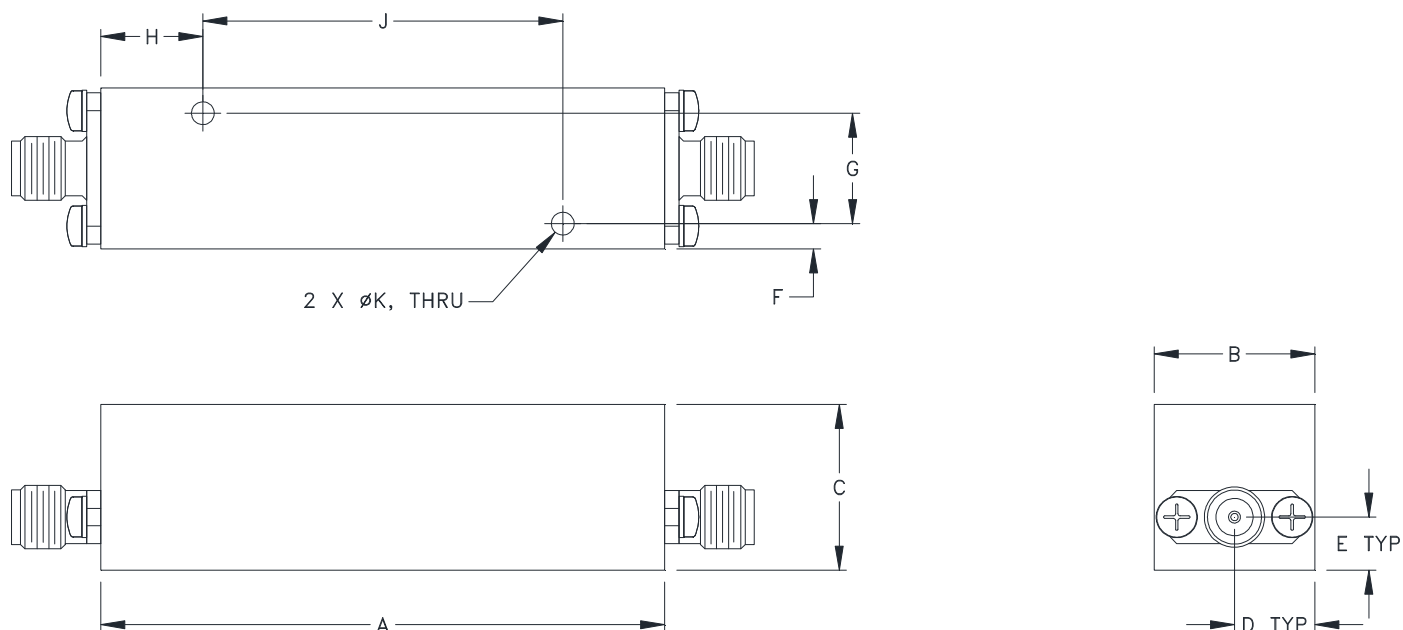

CASE#	A	B	C	D	E	F
UY3145	2.35 (59.7)	.67 (17.0)	.69 (17.5)	.34 (8.5)	.22 (5.6)	.11 (2.7)

CASE#	G	H	J	K	WT. GRAMS
UY3145	.460 (11.68)	.43 (10.8)	1.500 (38.10)	.095 (2.41)	130

Dimensions are in inches (mm). Tolerances: 2 Pl.  $\pm .100$ ; 3 Pl.  $\pm .015$

### Notes:

1. Case material: Brass alloy.
2. Case Finish: Powder coated over silver plating.
3. Refer to the individual model data sheet for the type of connectors available.



P.O. Box 350166, Brooklyn, New York 11235-0003 (718) 934-4500 Fax (718) 332-4661 For detailed performance specs & shopping online see Mini-Circuits web site



The Design Engineers Search Engine Provides ACTUAL Data Instantly From MINI-CIRCUITS At: [www.minicircuits.com](http://www.minicircuits.com)

RF/IF MICROWAVE COMPONENTS