

## Outline Dimensions

WM3323

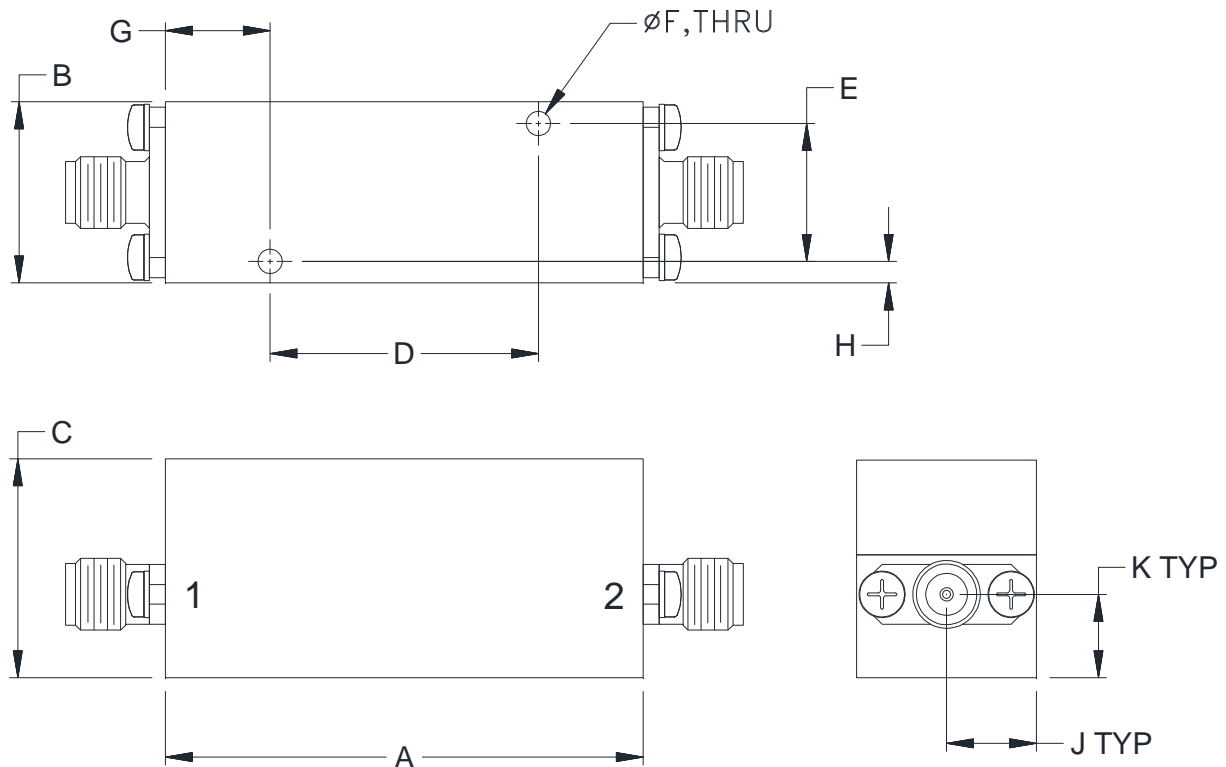

| CASE#  | A              | B             | C             | D                | E               | F              |
|--------|----------------|---------------|---------------|------------------|-----------------|----------------|
| WM3323 | 1.78<br>(45.2) | .67<br>(17.0) | .81<br>(20.6) | 1.000<br>(25.40) | .510<br>(12.95) | .090<br>(2.29) |

| CASE#  | G            | H            | J            | K            | WT. GRAMS |
|--------|--------------|--------------|--------------|--------------|-----------|
| WM3323 | .39<br>(9.9) | .08<br>(2.0) | .34<br>(8.5) | .31<br>(7.8) | 40        |

Dimensions are in inches (mm). Tolerances: 2 Pl.  $\pm .100$ ; 3 Pl.  $\pm .015$

### Notes:

1. Case material: Aluminum.
2. Case Finish: Powder coated.
3. Refer to the individual model data sheet for the type of connectors available.



P.O. Box 350166, Brooklyn, New York 11235-0003 (718) 934-4500 Fax (718) 332-4661 For detailed performance specs & shopping online see Mini-Circuits web site



The Design Engineers Search Engine Provides ACTUAL Data Instantly From MINI-CIRCUITS At: [www.minicircuits.com](http://www.minicircuits.com)

RF/IF MICROWAVE COMPONENTS