

Outline Dimensions

YJ3430

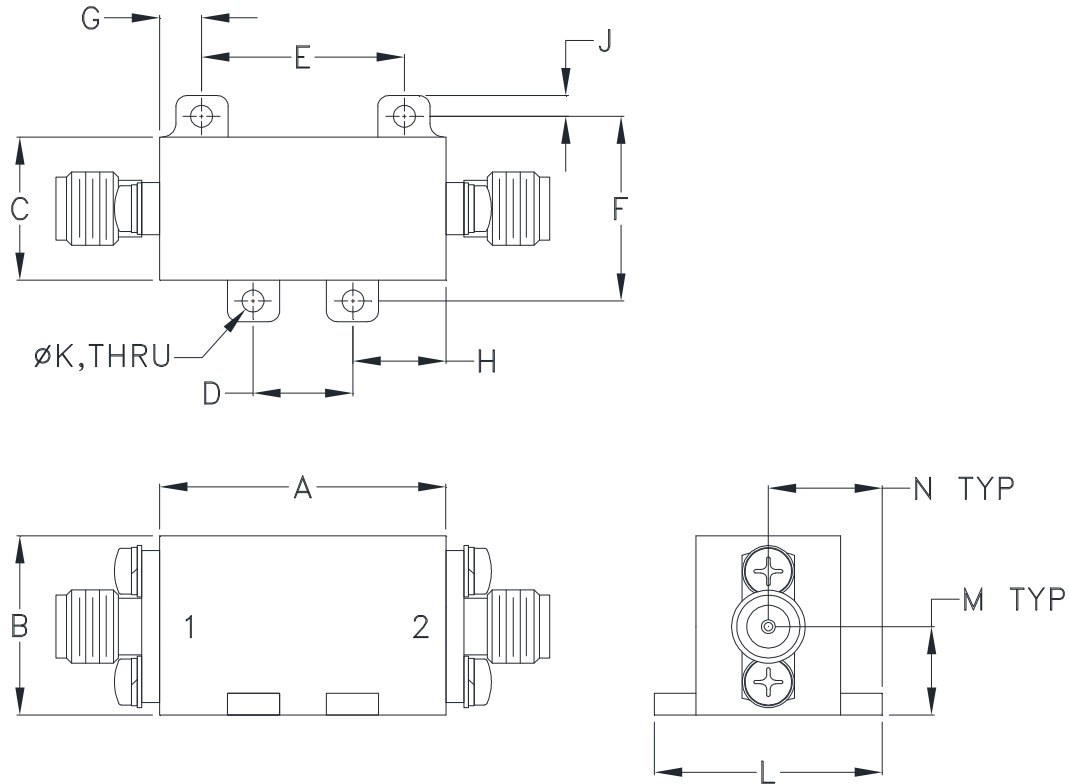

CASE#	A	B	C	D	E	F	G
YJ3430	1.03 (26.2)	.65 (16.5)	.52 (13.2)	.360 (9.14)	.730 (18.54)	.670 (17.02)	.15 (3.8)

CASE#	H	J	K	L	M	N	WT. GRAMS
YJ3430	.34 (8.5)	.07 (1.9)	.074 (1.88)	.82 (20.8)	.32 (8.1)	.41 (10.4)	46

Dimensions are in inches (mm). Tolerances: 2 Pl. $\pm .100$; 3 Pl. $\pm .015$

Notes:

1. Case material: Brass.
2. Case Finish: Powder coated.
3. Refer to the individual model data sheet for the type of connectors available.



P.O. Box 350166, Brooklyn, New York 11235-0003 (718) 934-4500 Fax (718) 332-4661 For detailed performance specs & shopping online see Mini-Circuits web site



The Design Engineers Search Engine Provides ACTUAL Data Instantly From MINI-CIRCUITS At: www.minicircuits.com

RF/IF MICROWAVE COMPONENTS