

## Outline Dimensions

YK3431

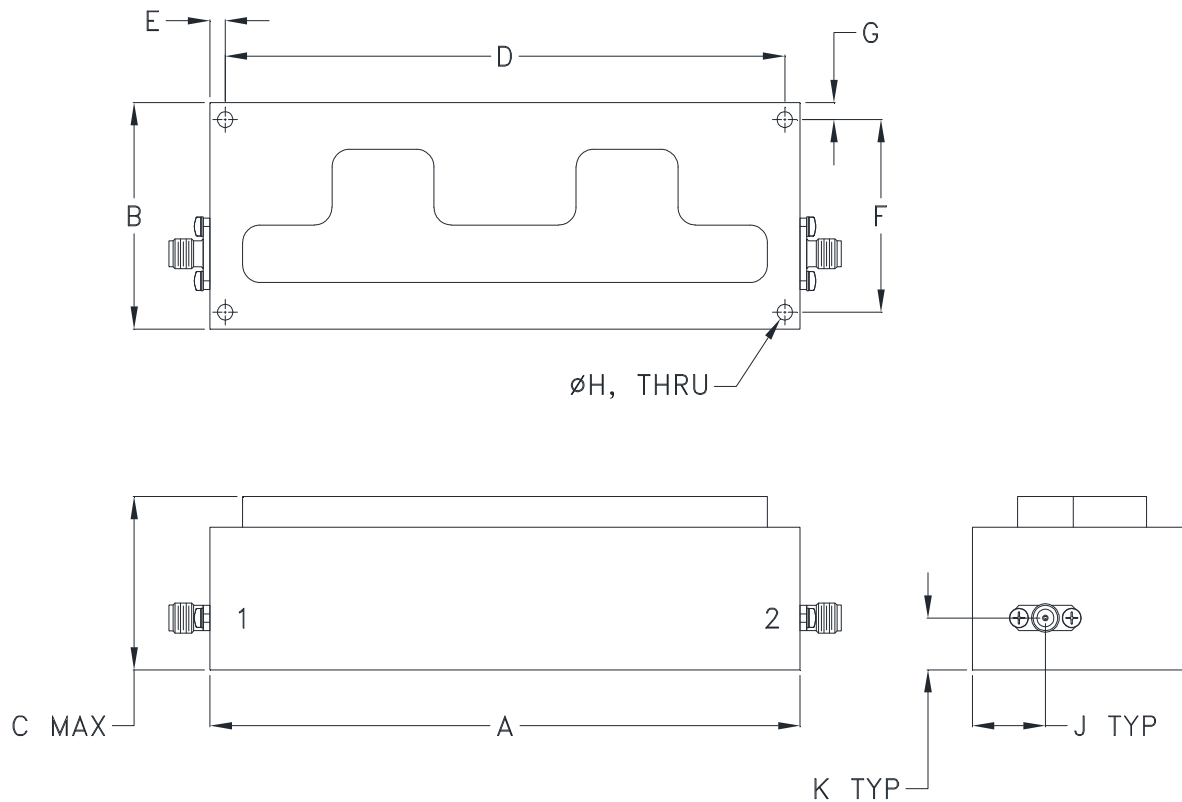

CASE#	A	B	C	D	E	F
YK3431	5.38 (136.7)	2.00 (50.8)	1.53 (38.9)	5.100 (129.54)	.14 (3.6)	1.700 (43.18)

CASE#	G	H	J	K	WT. GRAMS
YK3431	.15 (3.8)	.140 (3.55)	.67 (16.9)	.46 (11.6)	483

Dimensions are in inches (mm). Tolerances: 2 Pl.  $\pm .100$ ; 3 Pl.  $\pm .015$

### Notes:

1. Case material: Aluminum
2. Case Finish: Powder coated.
3. Refer to the individual model data sheet for the type of connectors available.



P.O. Box 350166, Brooklyn, New York 11235-0003 (718) 934-4500 Fax (718) 332-4661 For detailed performance specs & shopping online see Mini-Circuits web site



The Design Engineers Search Engine Provides ACTUAL Data Instantly From MINI-CIRCUITS At: [www.minicircuits.com](http://www.minicircuits.com)

RF/IF MICROWAVE COMPONENTS