

Case Style

BY

Outline Dimensions

BY493

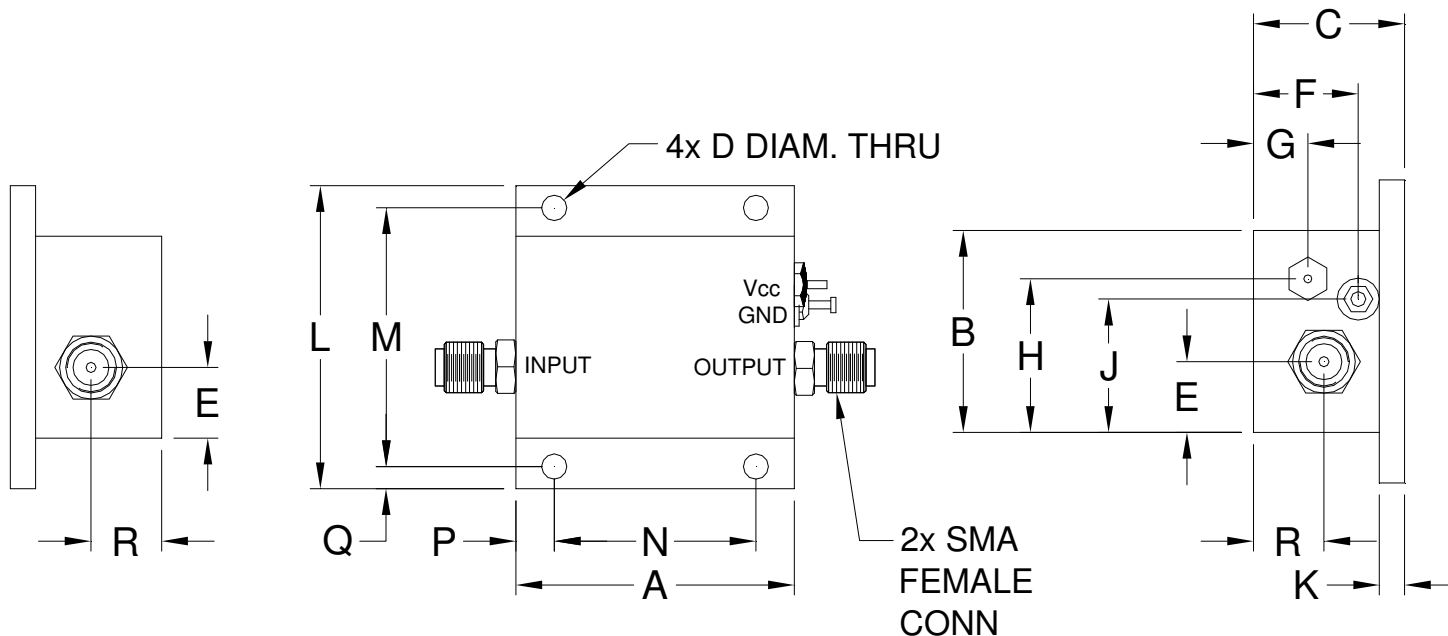

CASE#	A	B	C	D	E	F	G	H	J	K	L	M	N
BY493	1.38 (35.05)	1.00 (25.40)	.75 (19.05)	.125 (3.18)	.35 (8.89)	.52 (13.21)	.27 (6.86)	.76 (19.30)	.66 (16.76)	.125 (3.18)	1.50 (38.10)	1.281 (32.54)	1.000 (25.40)

CASE#	P	Q	R	WT. GRAMS
BY493	.19 (4.83)	.11 (2.79)	.35 (8.89)	40

Dimensions are in inches (mm). Tolerances: 2 Pl. $\pm .03$; 3 Pl. $\pm .015$

Notes:

1. Case material: Aluminum alloy.
2. Case finish: Clear chemical conversion coating, non-chrome or trivalent chrome based.

Mini-Circuits®

INTERNET <http://www.minicircuits.com>

P.O. Box 350166, Brooklyn, New York 11235-0003 (718) 934-4500 Fax (718) 332-4661

Distribution Centers NORTH AMERICA 800-654-7949 • 417-335-5935 • Fax 417-335-5945 • EUROPE 44-1252-832600 • Fax 44-1252-837010

Mini-Circuits ISO 9001 & ISO 14001 Certified