

Outline Dimensions

VY3280

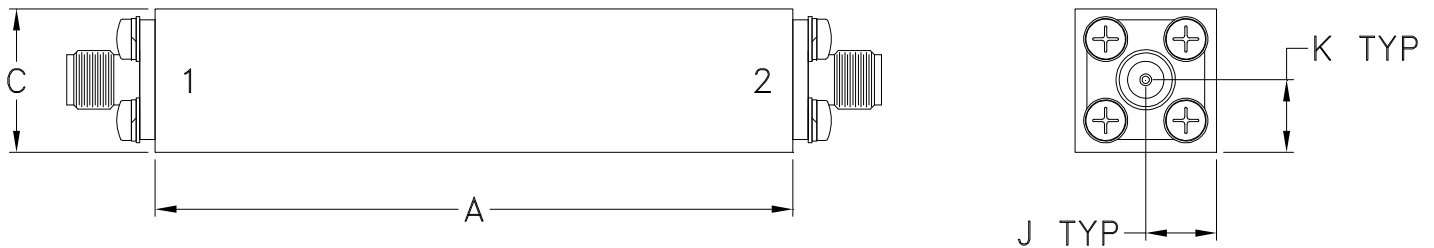
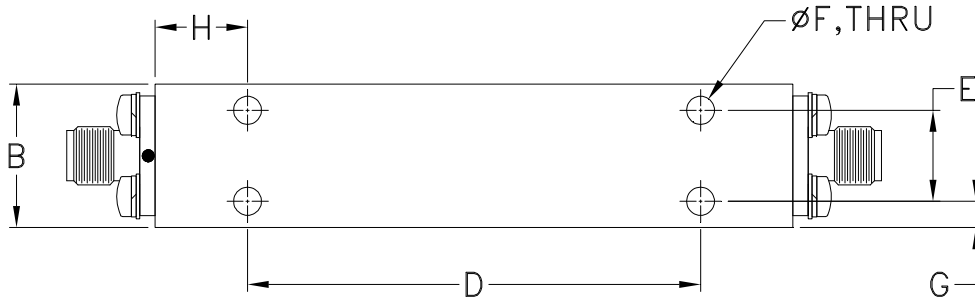

CASE#	A	B	C	D	E	F
VY3280	2.70 (68.7)	.60 (15.2)	.60 (15.2)	1.920 (48.77)	.380 (9.65)	.110 (2.80)

CASE#	G	H	J	K	WT. GRAMS
VY3280	.11 (2.8)	.39 (9.9)	.30 (7.6)	.30 (7.7)	120

Dimensions are in inches (mm). Tolerances: 2 Pl. $\pm .100$; 3 Pl. $\pm .015$

Notes:

1. Case material: Brass.
2. Case Finish: Powder coated over silver plating.
3. Refer to the individual model data sheet for the type of connectors available.



P.O. Box 350166, Brooklyn, New York 11235-0003 (718) 934-4500 Fax (718) 332-4661 For detailed performance specs & shopping online see Mini-Circuits web site



The Design Engineers Search Engine Provides ACTUAL Data Instantly From MINI-CIRCUITS At: www.minicircuits.com

RF/IF MICROWAVE COMPONENTS