

# Case Style

# WZ

## Outline Dimensions

## WZ3389

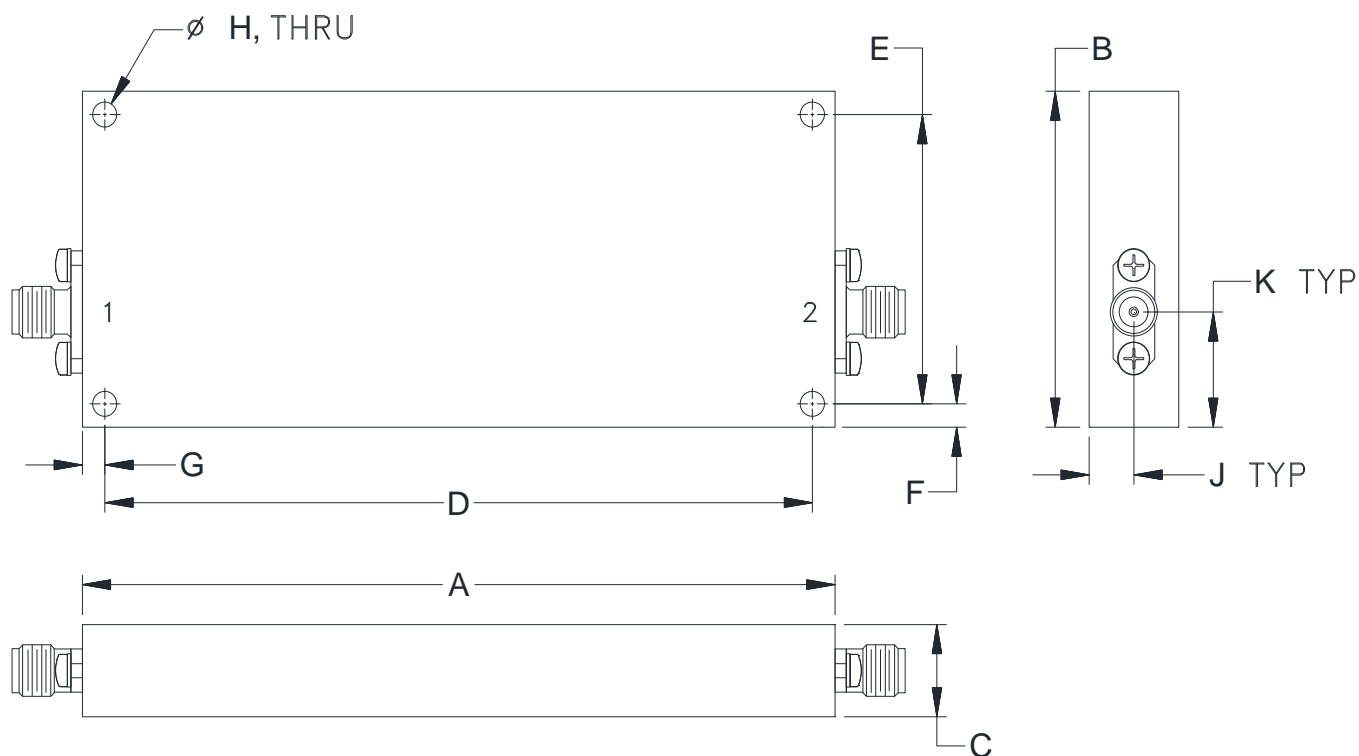

CASE#	A	B	C	D	E	F
WE3389	4.00 (101.6)	1.73 (43.9)	.48 (12.1)	3.760 (95.50)	1.490 (37.85)	.12 (3.0)

CASE#	G	H	J	K	WT. GRAMS
WE3389	.12 (3.0)	.130 (3.30)	.24 (6.0)	.59 (15.1)	210

Dimensions are in inches (mm). Tolerances: 2 Pl.  $\pm .100$ ; 3 Pl.  $\pm .015$

### Notes:

1. Case material: Brass.
2. Case Finish: Powder coated over silver plating.
3. Refer to the individual model data sheet for the type of connectors available.

**Mini-Circuits®**  
ISO 9001 ISO 14001 CERTIFIED

ALL NEW  
minicircuits.com

P.O. Box 350166, Brooklyn, New York 11235-0003 (718) 934-4500 Fax (718) 332-4661 For detailed performance specs & shopping online see Mini-Circuits web site



The Design Engineers Search Engine Provides ACTUAL Data Instantly From MINI-CIRCUITS At: [www.minicircuits.com](http://www.minicircuits.com)

RF/IF MICROWAVE COMPONENTS