

Voltage Controlled Oscillator

ZX95-3605+

Linear Tuning 3300 to 3605 MHz

Features

- linear tuning characteristics
- low pushing
- protected by US patent 6,790,049

Applications

- r & d
- lab
- instrumentation
- wireless communications
- WiMAX



CASE STYLE: GB956

Connectors	Model
SMA	ZX95-3605-S+

+RoHS Compliant
The +Suffix identifies RoHS Compliance. See our web site for RoHS Compliance methodologies and qualifications

Electrical Specifications

MODEL NO.	FREQ. (MHz)		POWER OUTPUT (dBm)	PHASE NOISE dBc/Hz SSB at offset frequencies, kHz				TUNING					NON HARMONIC SPURIOUS (dBc)	HARMONICS (dBc)		PULLING pk-pk @ 12 dB _r (MHz)	PUSHING (MHz/V)	DC OPERATING POWER	
	Min.	Max.		Typ.	1	10	100	1000	VOLTAGE RANGE (V)	SENSI- TIVITY (MHz/V)	PORT CAP (pF)	3 dB MODULATION BANDWIDTH (MHz)		Typ.	Typ.			Max.	Typ.
ZX95-3605+	3300	3605	+8.5	-71	-97	-118	-138	0.5	8	47-64	13	550	-90	-20	-15	3.5	0.6	5	46

Maximum Ratings

Operating Temperature	-55°C to 85°C
Storage Temperature	-55°C to 100°C
Absolute Max. Supply Voltage (V _{cc})	7V
Absolute Max. Tuning Voltage (V _{tune})	10V
All specifications	50 ohm system

Permanent damage may occur if any of these limits are exceeded.



NOTE: When soldering the DC connections, caution must be used to avoid overheating the DC terminals. See Application Note AN-40-10.

Outline Drawing

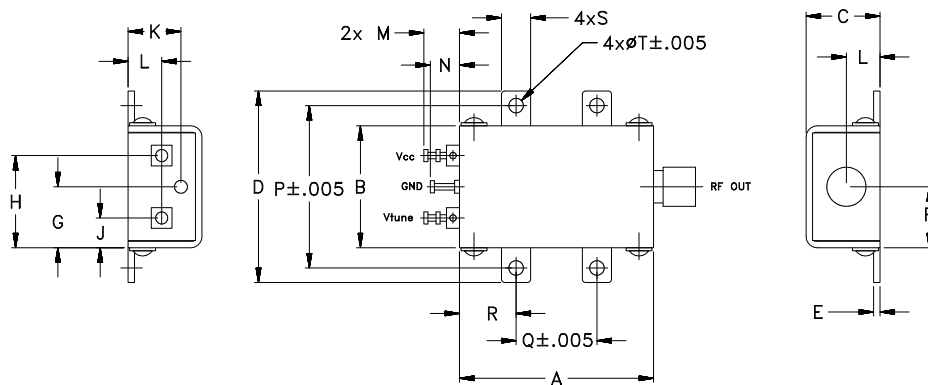

Outline Dimensions (inch/mm)

A	B	C	D	E	F	G	H	J	K	L	M	N	P	Q	R	S	T	wt.
1.20	.75	.46	1.18	.04	.38	.38	.57	.18	.33	.21	.22	.18	1.00	.50	.35	.18	.106	grams
30.48	19.05	11.68	29.97	1.02	9.65	9.65	14.48	4.57	8.38	5.33	5.59	4.57	25.40	12.70	8.89	4.57	2.69	35.0

Notes

- Performance and quality attributes and conditions not expressly stated in this specification document are intended to be excluded and do not form a part of this specification document.
- Electrical specifications and performance data contained in this specification document are based on Mini-Circuits' applicable established test performance criteria and measurement instructions.
- The parts covered by this specification document are subject to Mini-Circuits standard limited warranty and terms and conditions (collectively, "Standard Terms"); Purchasers of this part are entitled to the rights and benefits contained therein. For a full statement of the Standard Terms and the exclusive rights and remedies thereunder, please visit Mini-Circuits' website at www.minicircuits.com/MCLStore/terms.jsp



Performance Data & Curves*

ZX95-3605+

V TUNE	TUNE SENS (MHz/V)	FREQUENCY (MHz)			POWER OUTPUT (dBm)			Icc (mA)	HARMONICS (dBc)			FREQ. PUSH (MHz/V)	FREQ. PULL (MHz)	PHASE NOISE (dBc/Hz) at offsets				FREQ OFFSET (KHz)	PHASE NOISE at 3450 MHz (dBc/Hz)
		-55°C	+25°C	+85°C	-55°C	+25°C	+85°C		F2	F3	F4			1kHz	10kHz	100kHz	1MHz		
0.00	97.75	3198.0	3180.7	3167.1	8.69	8.25	7.77	39.85	-21.7	-31.7	-50.0	1.82	5.92	-68.1	-96.1	-117.5	-137.8	1.0	-70.61
0.25	92.50	3222.7	3205.1	3192.7	8.73	8.35	8.00	39.94	-21.6	-32.2	-49.7	1.01	4.48	-70.4	-96.7	-118.2	-138.3	2.0	-80.57
0.50	82.40	3244.6	3228.3	3214.4	8.77	8.40	8.12	39.92	-22.1	-31.6	-50.6	0.62	2.54	-75.4	-96.8	-117.6	-138.0	3.5	-85.08
1.00	73.44	3283.3	3267.7	3255.5	8.77	8.37	8.16	40.05	-21.1	-32.4	-50.0	0.19	5.56	-72.2	-98.4	-118.5	-138.6	6.0	-91.96
1.50	62.17	3316.8	3302.4	3290.6	8.87	8.40	8.16	40.21	-20.8	-32.6	-49.2	0.06	1.21	-69.9	-97.3	-118.3	-138.9	8.5	-95.06
2.00	63.54	3349.1	3333.2	3321.2	8.86	8.52	8.30	40.28	-20.4	-33.4	-49.2	0.01	4.78	-73.8	-96.4	-118.4	-138.2	10.0	-96.50
2.50	56.27	3378.9	3364.7	3351.5	8.92	8.47	8.30	40.35	-20.8	-33.7	-48.7	0.10	3.50	-75.7	-97.3	-119.1	-139.2	20.8	-103.70
3.00	52.94	3406.4	3392.4	3380.2	8.99	8.52	8.38	40.57	-19.9	-33.9	-48.1	0.04	2.74	-69.9	-95.6	-117.7	-137.3	35.5	-109.13
3.50	55.98	3434.8	3418.6	3406.2	8.98	8.60	8.49	40.66	-20.2	-34.1	-49.1	0.18	4.54	-72.3	-96.5	-118.3	-138.4	60.7	-113.47
4.00	52.98	3461.5	3446.5	3432.9	9.01	8.59	8.49	40.70	-20.7	-34.9	-50.0	0.28	2.93	-70.7	-96.8	-118.1	-138.6	86.7	-116.81
4.50	50.33	3487.1	3472.8	3459.3	9.04	8.57	8.52	40.89	-20.5	-34.8	-48.8	0.44	2.85	-69.2	-96.0	-118.5	-138.1	100.0	-118.25
5.00	50.29	3513.2	3497.7	3484.3	9.06	8.58	8.51	41.07	-19.8	-35.1	-46.5	0.64	4.30	-68.6	-96.0	-117.6	-137.4	148.1	-121.66
5.50	49.83	3538.5	3522.9	3509.0	9.12	8.62	8.56	41.17	-20.7	-35.3	-44.8	0.92	2.77	-69.8	-95.6	-117.6	-137.8	177.0	-123.51
6.00	50.78	3563.7	3547.8	3533.8	9.16	8.63	8.63	41.26	-20.8	-36.0	-44.1	1.21	2.38	-70.7	-95.8	-116.4	-136.8	211.6	-124.95
6.50	49.18	3588.7	3573.1	3558.3	9.18	8.60	8.67	41.40	-20.4	-36.1	-42.7	1.46	4.11	-70.2	-94.5	-116.8	-137.0	302.4	-128.33
7.00	47.12	3612.9	3597.4	3583.1	9.21	8.60	8.65	41.61	-20.2	-36.5	-41.9	1.70	3.19	-67.7	-94.6	-116.2	-136.4	361.5	-129.32
7.25	47.45	3625.4	3609.2	3595.2	9.20	8.65	8.66	41.68	-20.8	-36.7	-41.4	1.86	1.50	-66.9	-94.2	-116.3	-136.2	507.5	-132.22
7.50	49.99	3638.0	3621.0	3607.1	9.19	8.69	8.68	41.71	-21.3	-38.0	-40.8	2.00	1.75	-65.5	-93.7	-115.8	-136.0	606.7	-133.76
7.75	49.94	3650.3	3633.5	3618.9	9.18	8.70	8.72	41.71	-21.9	-38.0	-40.7	2.21	3.22	-65.2	-93.3	-115.5	-135.6	851.6	-136.87
8.00	49.29	3662.5	3646.0	3631.2	9.15	8.68	8.73	41.74	-21.8	-39.5	-40.8	2.25	3.71	-66.8	-93.1	-115.8	-135.6	1000.0	-138.27

*at 25°C unless mentioned otherwise

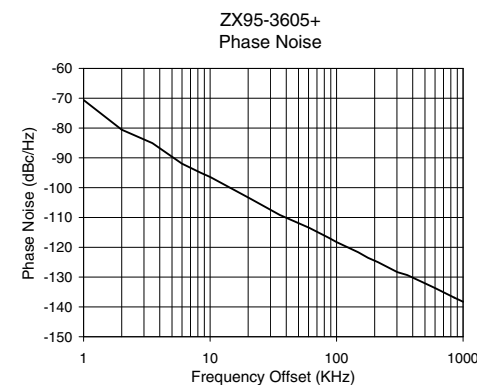
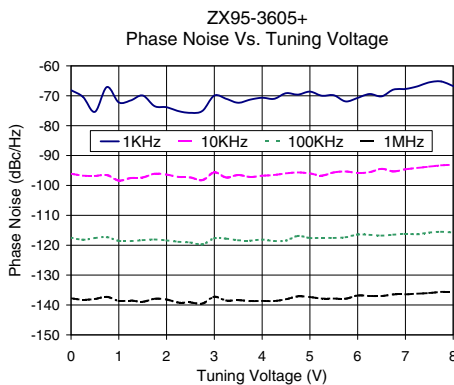
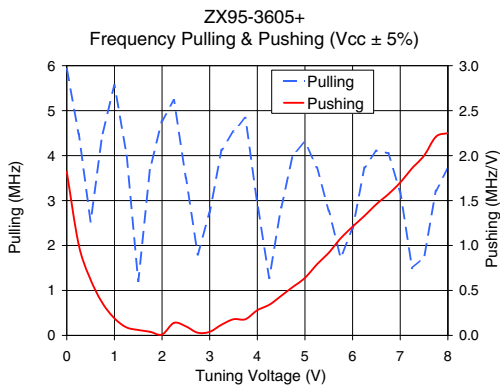
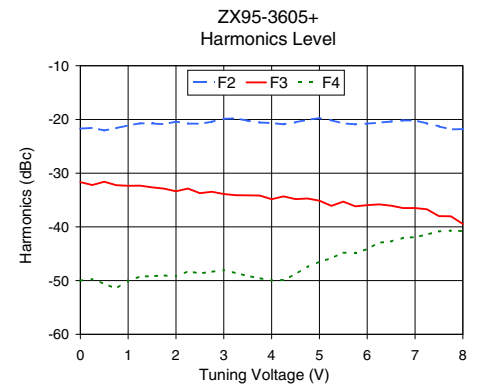
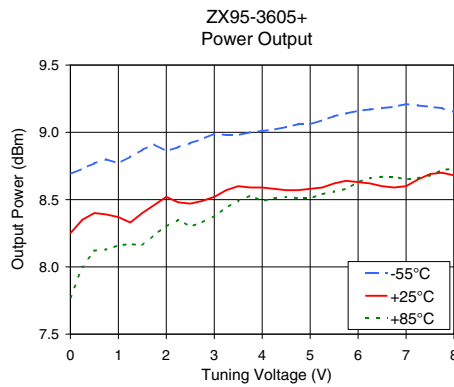
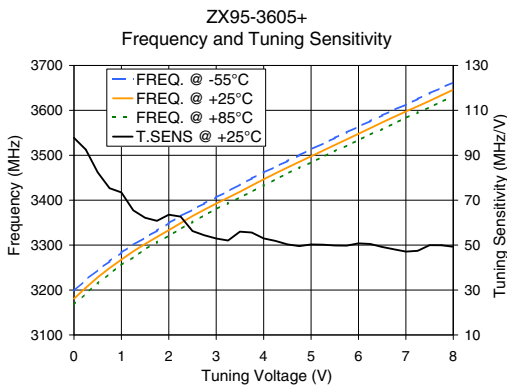

Notes

- A. Performance and quality attributes and conditions not expressly stated in this specification document are intended to be excluded and do not form a part of this specification document.
- B. Electrical specifications and performance data contained in this specification document are based on Mini-Circuit's applicable established test performance criteria and measurement instructions.
- C. The parts covered by this specification document are subject to Mini-Circuits standard limited warranty and terms and conditions (collectively, "Standard Terms"); Purchasers of this part are entitled to the rights and benefits contained therein. For a full statement of the Standard Terms and the exclusive rights and remedies thereunder, please visit Mini-Circuits' website at www.minicircuits.com/MCLStore/terms.jsp

