

# Case Style

# B

**B02**  
**B13**

## Outline Dimensions

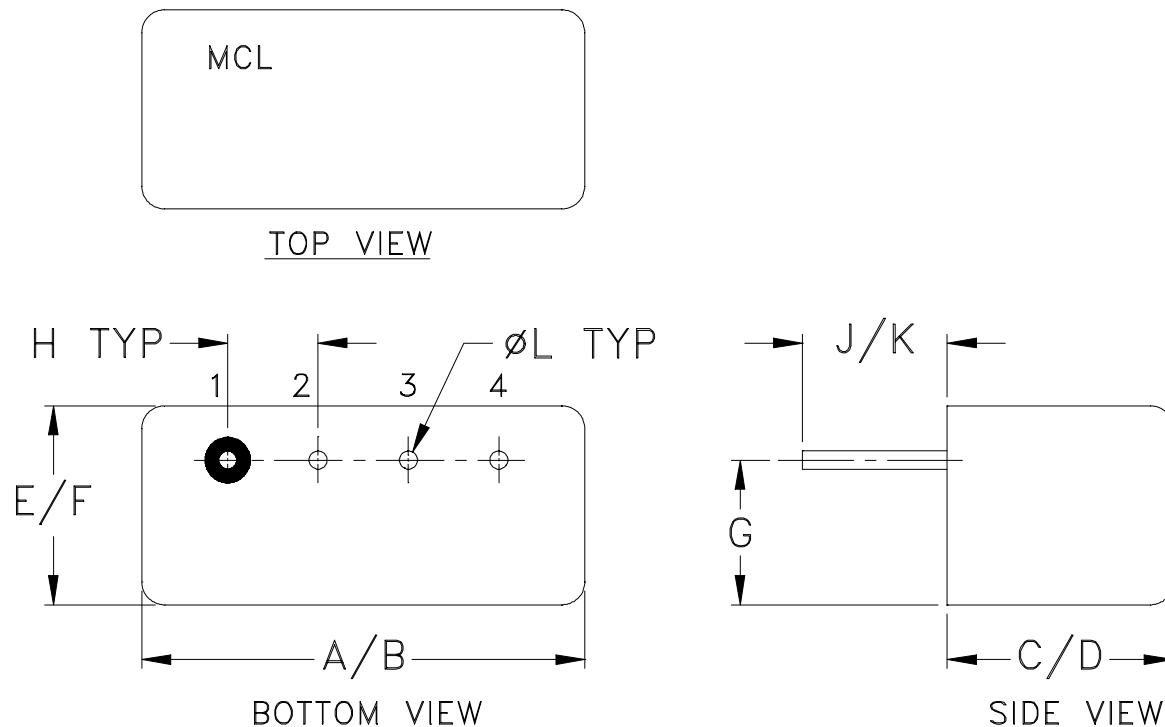

CASE#	A	B	C	D	E	F	G	H	J	K	L	WT, GRAM
B02	.480	.500	.240 (6.10)	.255 (6.48)	.210	.230 (5.84)	.16 (4.06)	.100 (2.54)	.14 (3.56)	.20 (5.08)	.020 (.51)	1.9
B13	(12.19)	(12.70)	.390 (9.91)	.405 (10.29)	(5.33)							2.3

Dimensions are in inches (mm). Tolerances: 2 Pl.  $\pm .03$ ; 3 Pl.  $\pm .015$

### Notes:

- Header material: C.R.S.  
Pin material: #52 alloy.  
Cover material: Cupro-Nickel.
- Pin finish: Electro Tin-Silver.
- Tolerance on pin diameter  $\pm .005$  inch.
- Glass meniscus 0.015 inch max.
- Blue bead indicates Pin 1. Pin numbers do not appear on unit, for reference only.

**Mini-Circuits**<sup>®</sup>

INTERNET <http://www.minicircuits.com>

P.O. Box 350166, Brooklyn, New York 11235-0003 (718) 934-4500 Fax (718) 332-4661

Distribution Centers NORTH AMERICA 800-654-7949 • 417-335-5935 • Fax 417-335-5945 • EUROPE 44-1252-832600 • Fax 44-1252-837010

Mini-Circuits ISO 9001 & ISO 14001 Certified