

## Outline Dimensions

BAU3709

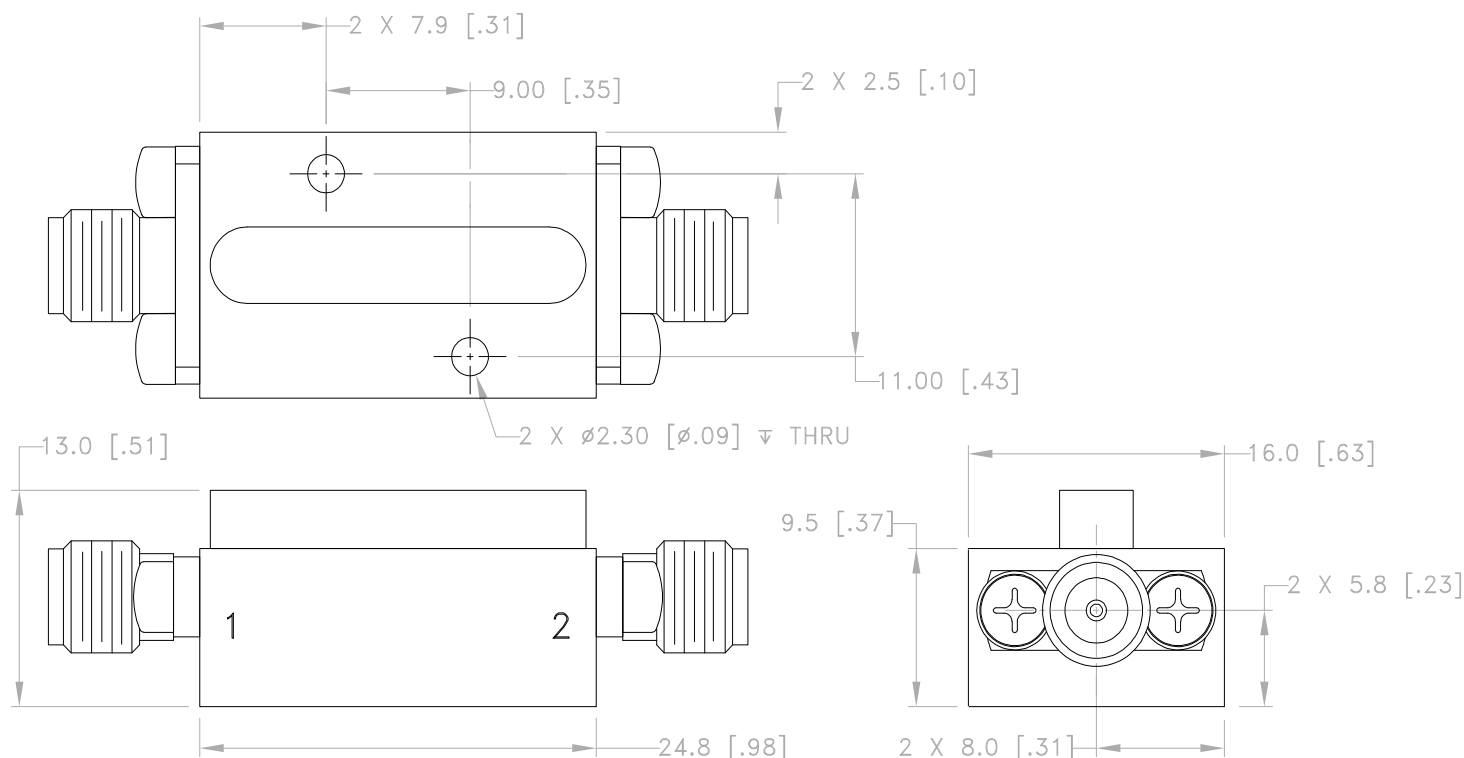

Dimensions are in mm (inches). Tolerances: 1 Pl.  $\pm 1.5$  (0.06); 2 Pl.  $\pm 0.38$  (0.015)

### Notes:

1. Case material: Brass alloy.
2. Case Finish: Powder coated.
3. Unit Weight: 35 grams.
4. Refer to the individual model data sheet for the type of connectors available.



P.O. Box 350166, Brooklyn, New York 11235-0003 (718) 934-4500 Fax (718) 332-4661 For detailed performance specs & shopping online see Mini-Circuits web site



The Design Engineers Search Engine Provides ACTUAL Data Instantly From MINI-CIRCUITS At: [www.minicircuits.com](http://www.minicircuits.com)

RF/IF MICROWAVE COMPONENTS

