

Outline Dimensions

BBA3697

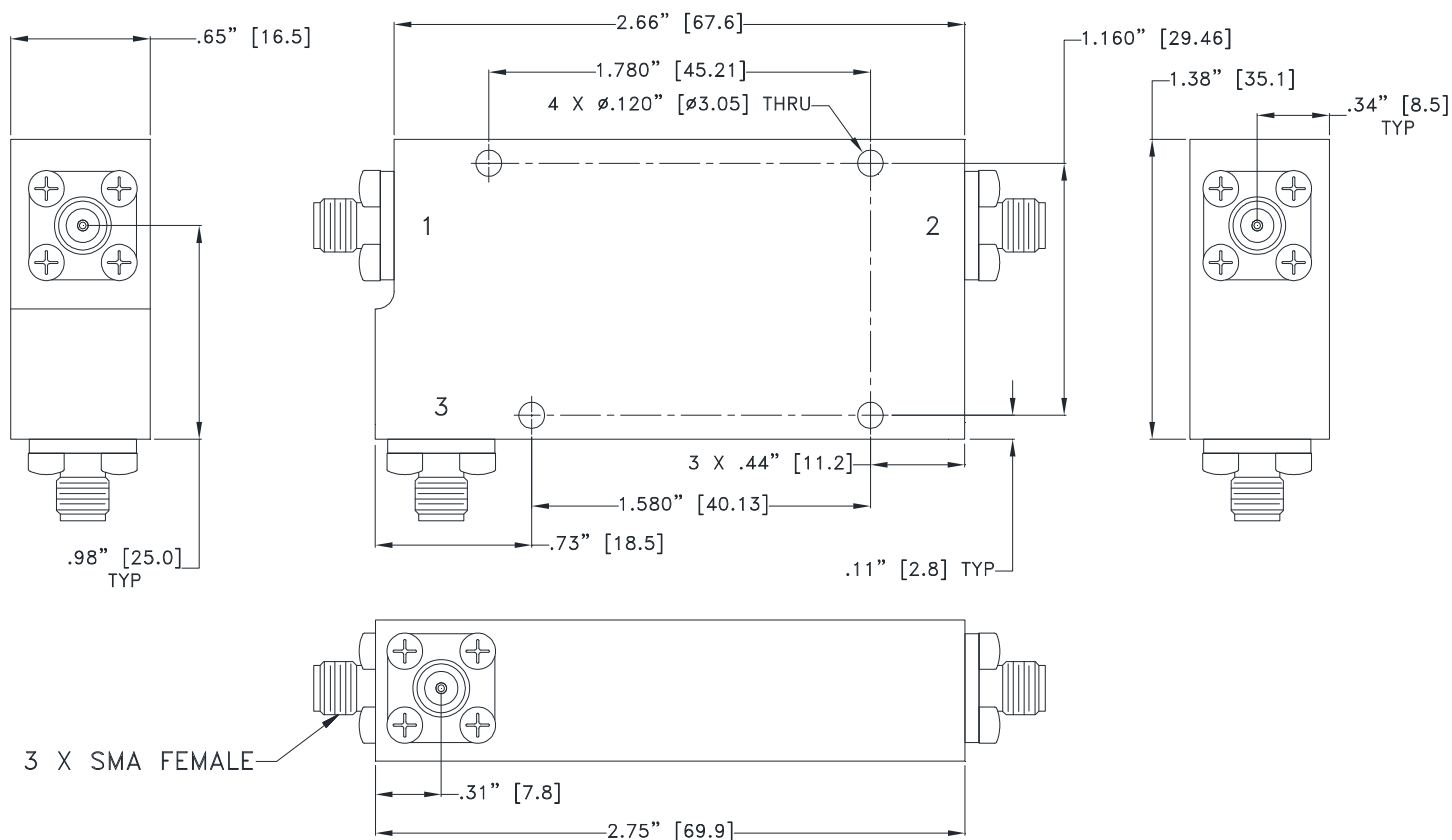

Dimensions are in inches [mm]. Tolerances: 2 Pl. ± 0.06 [1.52]; 3 Pl. ± 0.015 [0.381]

Notes:

1. Case material: Aluminum.
2. Case Finish: Powder coated.
3. Unit Weight: 150 grams.
4. Refer to the individual model data sheet for the type of connectors available.



P.O. Box 350166, Brooklyn, New York 11235-0003 (718) 934-4500 Fax (718) 332-4661 For detailed performance specs & shopping online see Mini-Circuits web site



The Design Engineers Search Engine Provides ACTUAL Data Instantly From MINI-CIRCUITS At: www.minicircuits.com

RF/IF MICROWAVE COMPONENTS