

Outline Dimensions

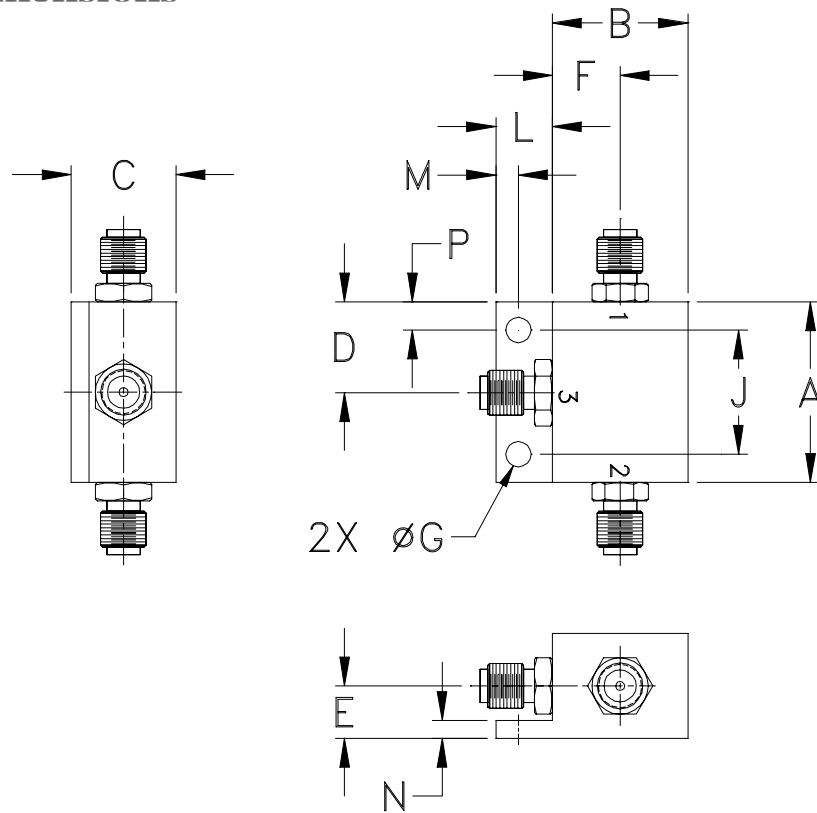

CASE#	A	B	C	D	E	F	G	H	J	K	L	M	N
BU413	1.00 (25.40)	.75 (19.05)	.58 (14.73)	.50 (12.70)	.29 (7.37)	.38 (9.65)	.140 (3.56)	--	.687 (17.45)	--	.32 (8.13)	.13 (3.30)	.10 (2.54)

CASE#	P	WT. GRAMS
BU413	.16 (4.06)	25

Dimensions are in inches (mm). Tolerances: 2 Pl. $\pm .03$; 3 Pl. $\pm .015$

Notes:

- Case material: Aluminum alloy.
- Case finish:
For RoHS Case Styles: Clear chemical conversion coating, non-chrome or trivalent chrome based.

Mini-Circuits[®]

INTERNET <http://www.minicircuits.com>

P.O. Box 350166, Brooklyn, New York 11235-0003 (718) 934-4500 Fax (718) 332-4661

Distribution Centers NORTH AMERICA 800-654-7949 • 417-335-5935 • Fax 417-335-5945 • EUROPE 44-1252-832600 • Fax 44-1252-837010

Mini-Circuits ISO 9001 & ISO 14001 Certified