

DJ1821

Outline Dimensions

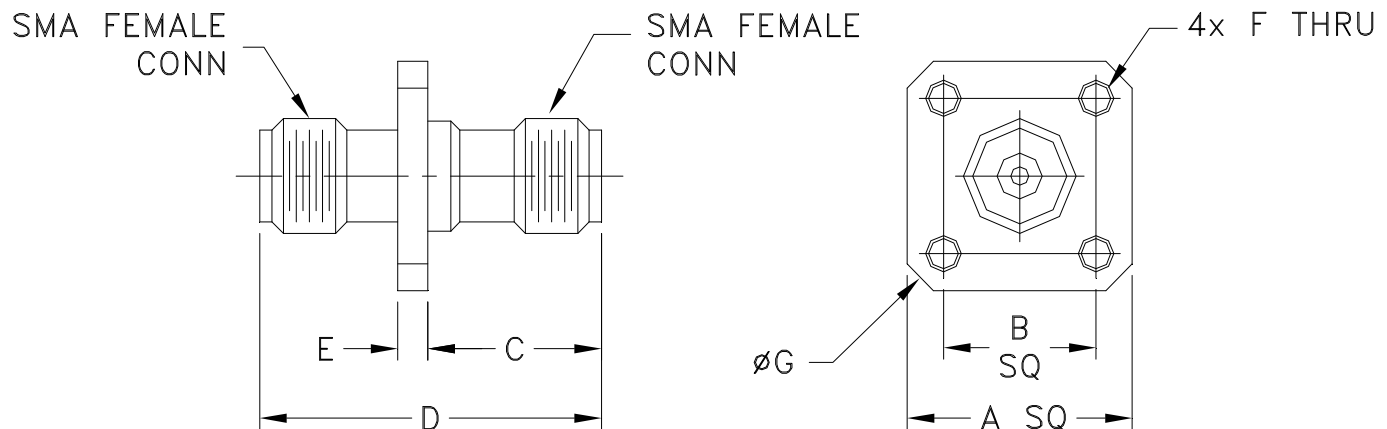

CASE #	A	B	C	D	E	F	G	WT. GRAM
DJ1821	.50 (12.7)	.339 (8.6)	.39 (9.8)	.76 (19.3)	.07 (1.7)	(M2 x 0.4P)	.63 (16.0)	3.6

Dimensions are in inches (mm). Tolerances: 2 Pl. $\pm .03$; 3Pl. + .015

Notes:

1. Case material:Stainless Steel.
2. Finish: Passivation.

Mini-Circuits®
ISO 9001 ISO 14001 CERTIFIED

ALL NEW
minicircuits.com

P.O. Box 350166, Brooklyn, New York 11235-0003 (718) 934-4500 Fax (718) 332-4661 For detailed performance specs & shopping online see Mini-Circuits web site



The Design Engineers Search Engine Provides ACTUAL Data Instantly From MINI-CIRCUITS At: www.minicircuits.com

RF/IF MICROWAVE COMPONENTS