

# Case Style

# F

## F1908-3

### Outline Dimensions

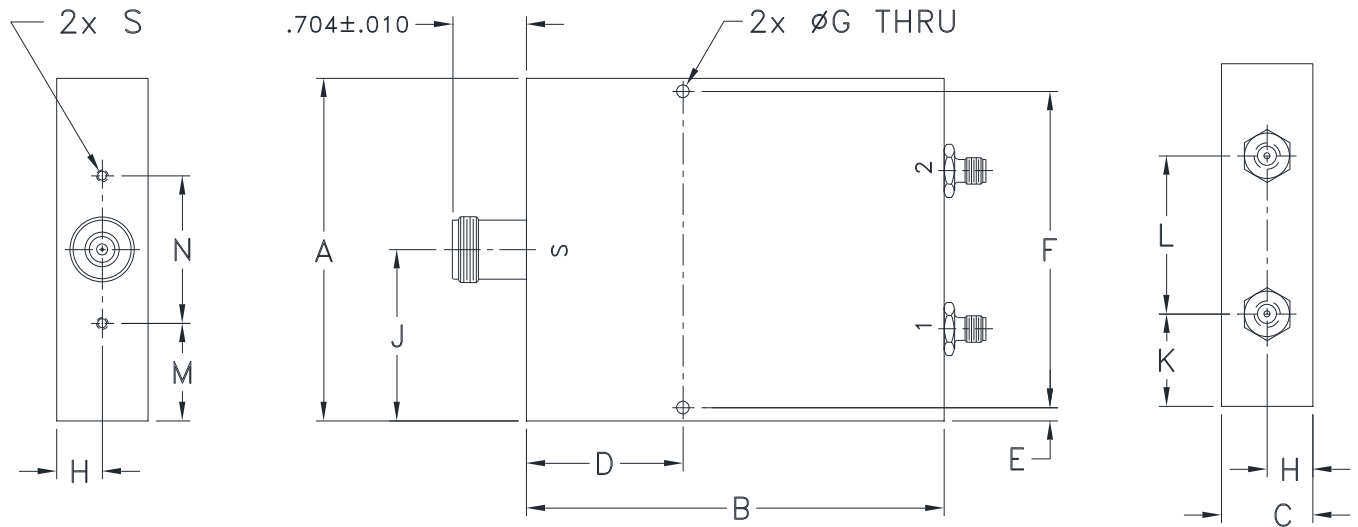

CASE #	A	B	C	D	E	F	G	H	J	K	L	M
F1908-3	3.25 (82.55)	4.00 (101.60)	.88 (22.35)	1.50 (38.10)	.13 (3.18)	3.000 (76.20)	.125 (3.18)	.44 (11.18)	1.63 (41.40)	.88 (22.35)	1.500 (38.10)	.93 (23.62)

CASE #	N	P	Q	R	S	WT. GRAM
F1908-3	1.400 (35.56)	-	-	-	#4-40, .156 DP	300.0

Dimensions are in inches (mm). Tolerances: 2Pl. ± .03; 3Pl. ± .015

#### Notes:

- Case material: Aluminum alloy.
- Case finish:  
For RoHS Case Styles: Clear chemical conversion coating, non-chrome or trivalent chrome based.
- Refer to the individual model data sheet for the type of connectors available.

**Mini-Circuits®**

Distribution Centers NORTH AMERICA 800-654-7949 • 417-335-5935 • Fax 417-335-5945 • EUROPE 44-1252-832600 • Fax 44-1252-837010

Mini-Circuits ISO 9001 & ISO 14001 Certified

INTERNET <http://www.minicircuits.com>

P.O. Box 350166, Brooklyn, New York 11235-0003 (718) 934-4500 Fax (718) 332-4661