

Outline Dimensions

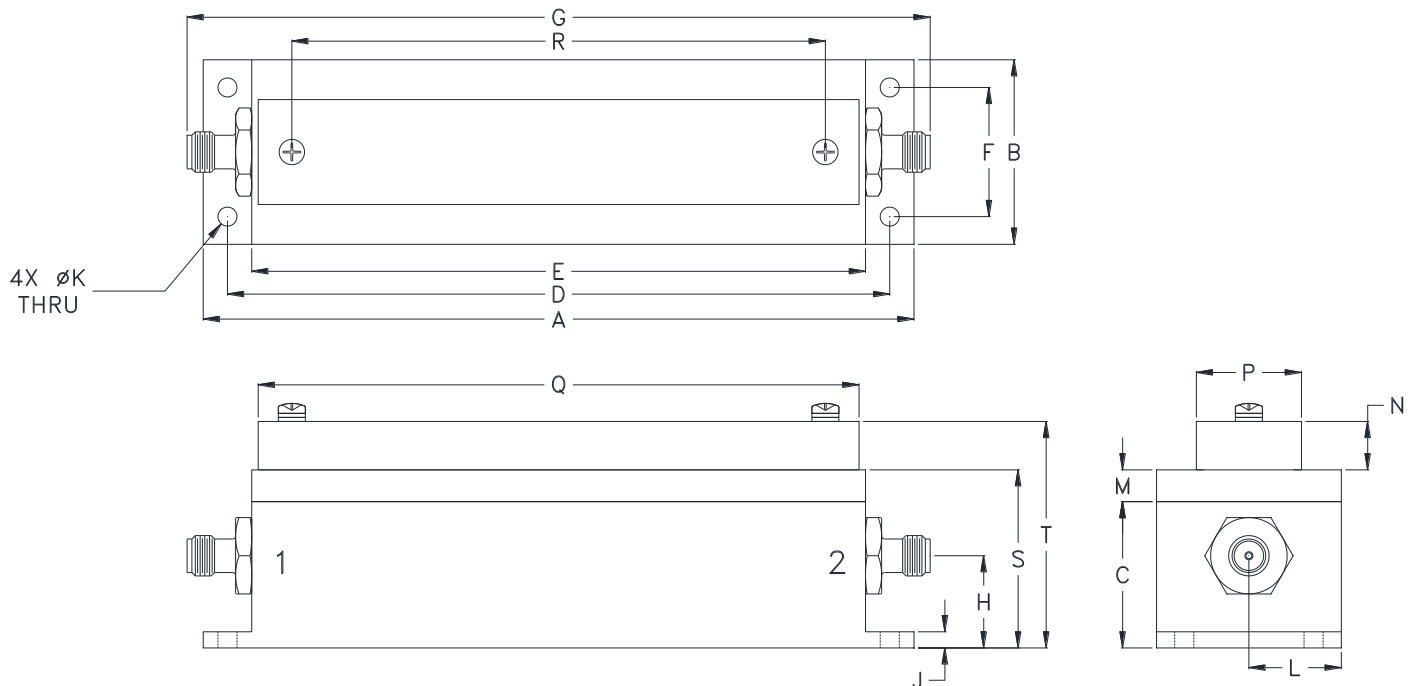

CASE #.	A	B	C	D	E	F	G	H	J	K	L	M	N	P
ME1656	4.40 (111.66)	1.14 (29.03)	0.91 (23.01)	4.096 (104.04)	3.80 (96.42)	0.800 (20.32)	4.60 (116.74)	0.57 (14.50)	0.10 (2.54)	0.118 (3.00)	0.57 (14.53)	0.20 (5.00)	0.30 (7.62)	0.65 (16.51)

CASE #.	Q	R	S	T	WT, GRAM
ME1656	3.72 (94.39)	3.30 (83.82)	1.10 (28.02)	1.40 (35.64)	160

Dimensions are in inches (mm). Tolerances: 2Pl. $\pm .03$; 3Pl. $\pm .015$

Notes:

- Case material: Aluminum alloy.
- Case finish:
 - Case & Cover of the units – Polyurethane spray painted over silver plated.
 - Tuning screw protective cover – Polyurethane spray painted over aluminum.
- Refer to the individual model data sheet for the type of connectors available.