

Outline Dimensions

UA2888

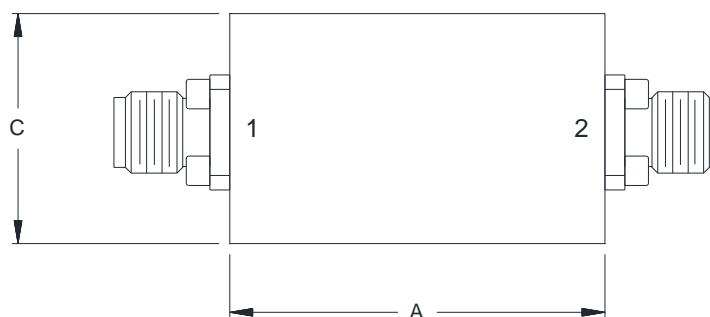
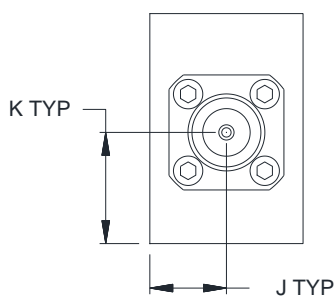
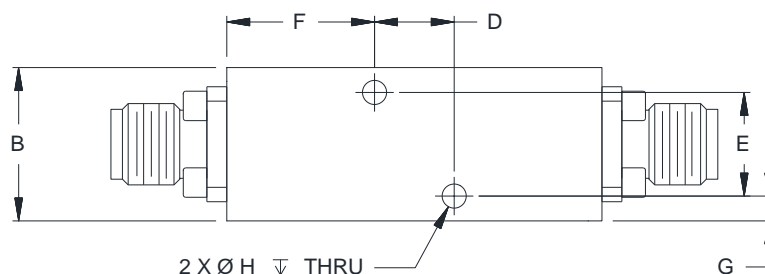

CASE#	A	B	C	D	E	F
UA2888	1.22 (31.1)	.50 (12.7)	.75 (19.1)	.260 (6.60)	.338 (8.59)	.48 (12.2)

CASE#	G	H	J	K	WT.GRAMS
UA2888	.08 (2.1)	.079 (2.00)	.25 (6.4)	.36 (9.2)	57

Dimensions are in inches (mm). Tolerances: 2 Pl. $\pm .100$; 3 Pl. $\pm .015$

Notes:

1. Case material: Brass alloy.
2. Case Finish:
 - a. Case & Cover of the units – Polyurethane spray painted over silver plating.
3. Refer to the individual model data sheet for the type of connectors available.



P.O. Box 350166, Brooklyn, New York 11235-0003 (718) 934-4500 Fax (718) 332-4661 For detailed performance specs & shopping online see Mini-Circuits web site



The Design Engineers Search Engine Provides ACTUAL Data Instantly From MINI-CIRCUITS At: www.minicircuits.com

RF/IF MICROWAVE COMPONENTS