

Outline Dimensions

UU1305-1

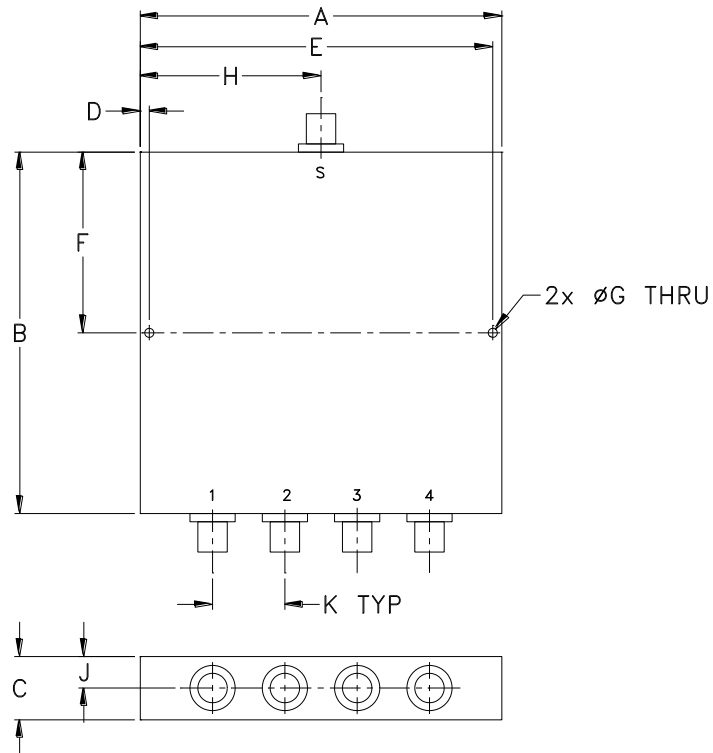

CASE#	A	B	C	D	E	F	G	H	J	K	WT. GRAMS
UU1305-1	5.00 (127.00)	5.00 (127.00)	.88 (22.35)	.13 (3.30)	4.875 (123.83)	2.50 (63.50)	.125 (3.18)	2.50 (63.50)	.44 (11.18)	1.000 (25.40)	560

Dimensions are in inches (mm). Tolerances: 2 Pl. $\pm .03$; 3 Pl. $\pm .015$

Notes:

1. Case material: Aluminum alloy.
2. Case finish:
For RoHS Case Styles: Clear chemical conversion coating, non-chrome or trivalent chrome based.
3. Refer to the individual model data sheet for the type of connectors available.



P.O. Box 350166, Brooklyn, New York 11235-0003 (718) 934-4500 Fax (718) 332-4661 For detailed performance specs & shopping online see Mini-Circuits web site



The Design Engineers Search Engine Provides ACTUAL Data Instantly From MINI-CIRCUITS At: www.minicircuits.com

RF/IF MICROWAVE COMPONENTS