

## Outline Dimensions

UU182

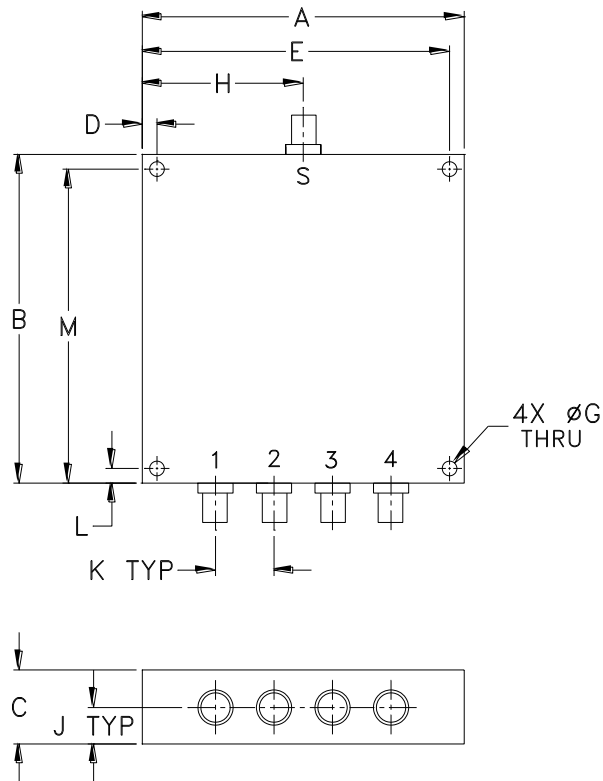

CASE#	A	B	C	D	E	F	G	H	J	K	L	M	WT. GRAMS
UU182	2.75 (69.85)	2.80 (71.12)	.63 (16.00)	.125 (3.18)	2.625 (66.68)	--	.125 (3.18)	1.38 (35.05)	.31 (7.87)	.500 (12.70)	.125 (3.18)	2.675 (67.95)	140

Dimensions are in inches (mm). Tolerances: 2 Pl.  $\pm .03$ ; 3 Pl.  $\pm .015$

### Notes:

- Case material: Aluminum alloy.
- Case finish:  
For RoHS Case Styles: Clear chemical conversion coating, non-chrome or trivalent chrome based.
- Refer to the individual model data sheet for the type of connectors available.



P.O. Box 350166, Brooklyn, New York 11235-0003 (718) 934-4500 Fax (718) 332-4661 For detailed performance specs & shopping online see Mini-Circuits web site



The Design Engineers Search Engine Provides ACTUAL Data Instantly From MINI-CIRCUITS At: [www.minicircuits.com](http://www.minicircuits.com)

RF/IF MICROWAVE COMPONENTS