

## Outline Dimensions

UU187

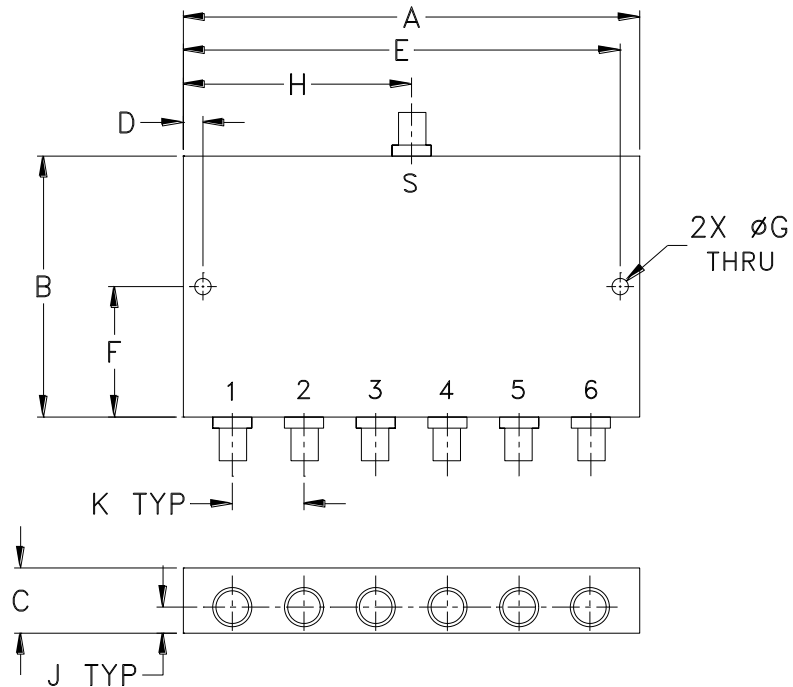

CASE#	A	B	C	D	E	F	G	H	J	K	WT. GRAMS
UU187	6.00 (152.40)	1.62 (41.15)	.88 (22.35)	.250 (6.35)	5.750 (146.05)	.810 (20.57)	.144 (3.66)	3.00 (76.20)	.44 (11.18)	1.00 (25.40)	340

Dimensions are in inches (mm). Tolerances: 2 Pl.  $\pm .03$ ; 3 Pl.  $\pm .015$

### Notes:

- Case material: Aluminum alloy.
- Case finish:  
For RoHS Case Styles: Clear chemical conversion coating, non-chrome or trivalent chrome based.
- Refer to the individual model data sheet for the type of connectors available.



P.O. Box 350166, Brooklyn, New York 11235-0003 (718) 934-4500 Fax (718) 332-4661 For detailed performance specs & shopping online see Mini-Circuits web site



The Design Engineers Search Engine Provides ACTUAL Data Instantly From MINI-CIRCUITS At: [www.minicircuits.com](http://www.minicircuits.com)

RF/IF MICROWAVE COMPONENTS