

Case Style

UU

Outline Dimensions

UU2624-2

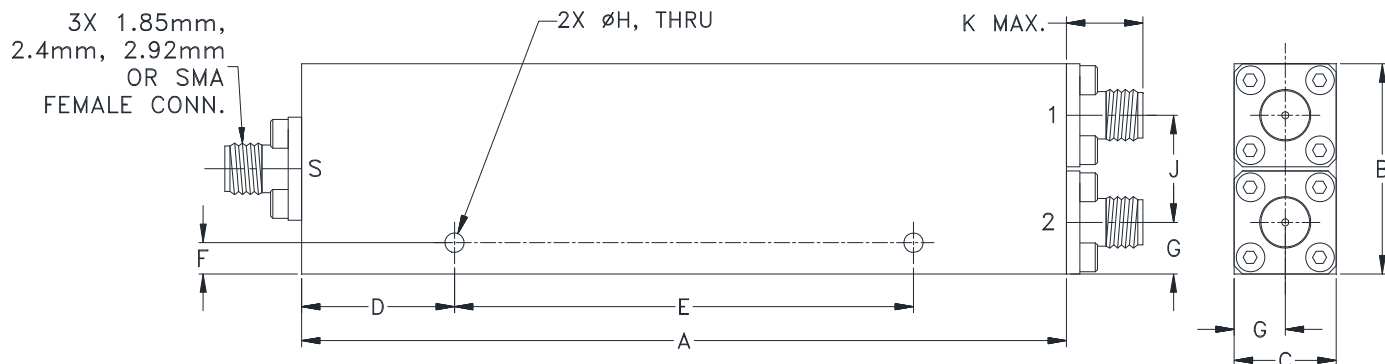

CASE #	A	B	C	D	E	F	G	H	J	K
UU2624-2	3.75 (95.25)	1.02 (25.91)	.50 (12.70)	.750 (19.05)	2.250 (57.15)	.151 (3.84)	.25 (6.35)	.094 (2.40)	.52 (13.21)	.43 (11.0)

CASE #	WT. GRAM
UU2624-2	100

Dimensions are in inches (mm). Tolerances: 2 Pl. \pm .03; 3 Pl. \pm .015

Notes:

1. Case material: Aluminum alloy.
2. Case finish: Painting Color: Blue.
3. Refer to the individual model data sheet for the type of connectors available.

Mini-Circuits®
ISO 9001 ISO 14001 CERTIFIED

ALL NEW
minicircuits.com

P.O. Box 350166, Brooklyn, New York 11235-0003 (718) 934-4500 Fax (718) 332-4661 For detailed performance specs & shopping online see Mini-Circuits web site



The Design Engineers Search Engine Provides ACTUAL Data Instantly From MINI-CIRCUITS At: www.minicircuits.com

RF/IF MICROWAVE COMPONENTS