

Outline Dimensions

YL3242

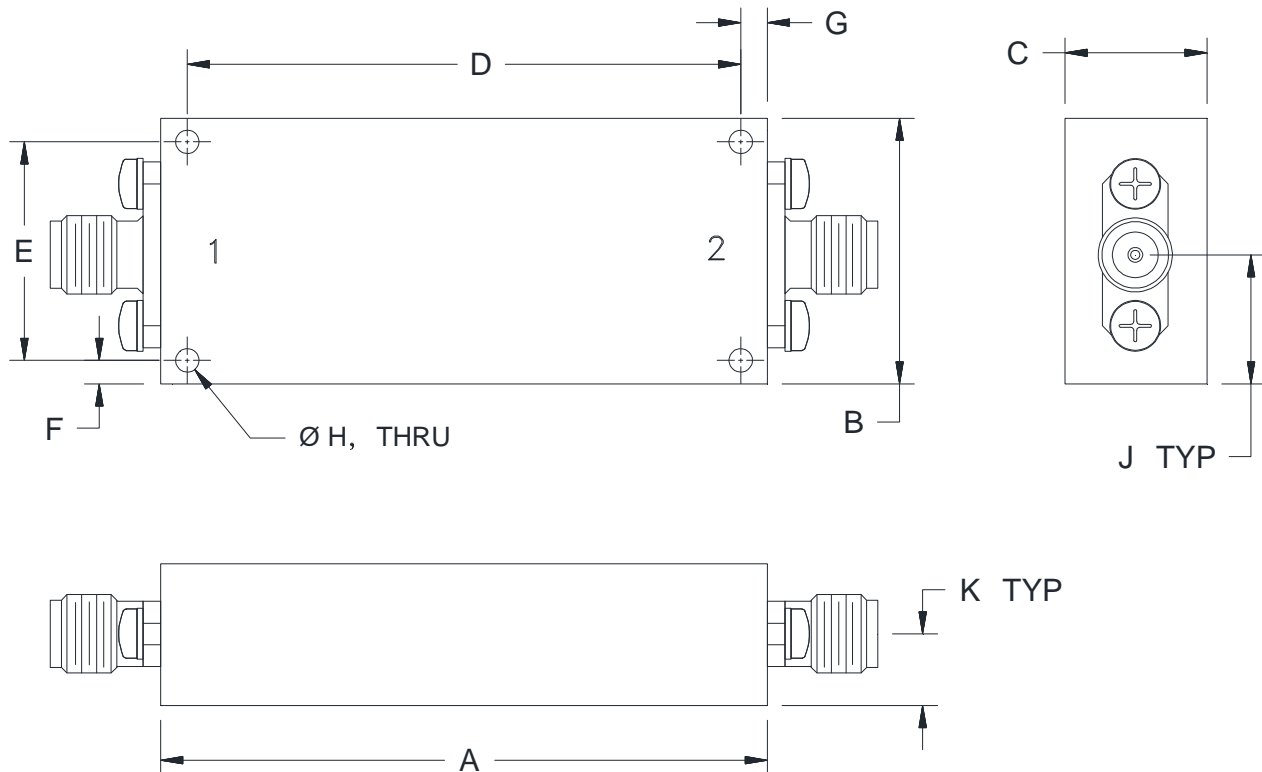

CASE#	A	B	C	D	E	F
YL3242	2.05 (52.1)	.90 (22.9)	.48 (12.2)	1.870 (47.50)	.740 (18.80)	.08 (2.0)

CASE#	G	H	J	K	WT. GRAMS
YL3242	.09 (2.3)	.080 (2.03)	.44 (11.1)	.24 (6.2)	80

Dimensions are in inches (mm). Tolerances: 2 Pl. $\pm .100$; 3 Pl. $\pm .015$

Notes:

1. Case material: Brass.
2. Case Finish: Powder coated.
3. Refer to the individual model data sheet for the type of connectors available.

Mini-Circuits®
ISO 9001 ISO 14001 CERTIFIED

ALL NEW
minicircuits.com

P.O. Box 350166, Brooklyn, New York 11235-0003 (718) 934-4500 Fax (718) 332-4661 For detailed performance specs & shopping online see Mini-Circuits web site



The Design Engineers Search Engine Provides ACTUAL Data Instantly From MINI-CIRCUITS At: www.minicircuits.com

RF/IF MICROWAVE COMPONENTS