

**SUGGESTED MOUNTING CONFIGURATION  
FOR GE0805C-20 CASE STYLE**

COPLANAR WAVEGUIDE:  
.025±.001 TRACE WIDTH &  
.010±.001 GAP, 2 PL.  
(SEE NOTE 2)

∅.014 PTH  
FOR GROUND

PACKAGE  
OUTLINE

∅.014 PTH, PLUGGED WITH  
EPOXY AND CAPPED WITH  
COPPER, 2 PL.

PIN 1

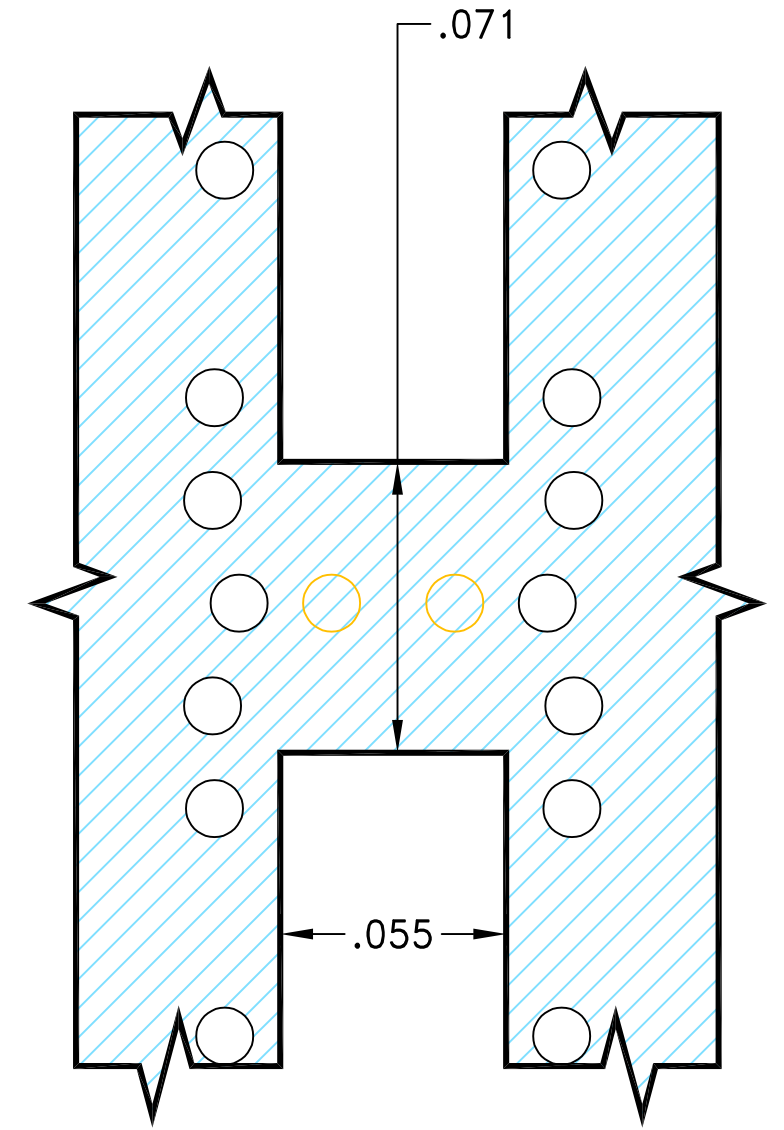

TOP VIEW TO LAYER 2

**STACK-UP DIAGRAM**

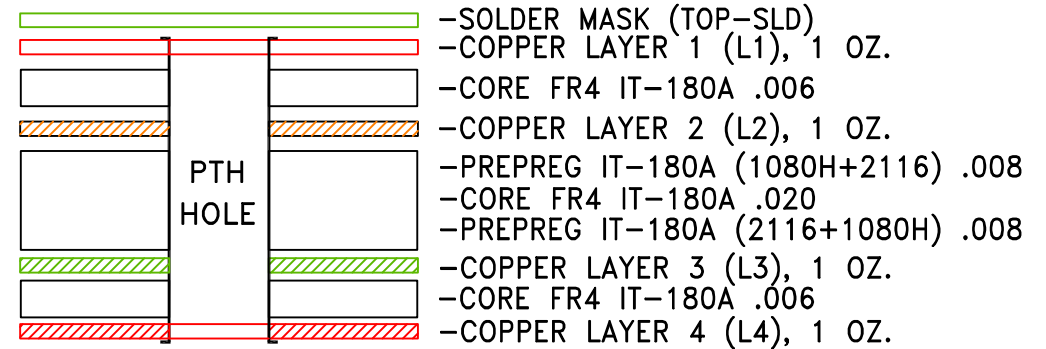

- TOTAL FINISHED THICKNESS 0.056±10% ∅.
- PTH PRESENT FROM COPPER LAYER 1 TO COPPER LAYER 4.

**NOTES:**

- PCB IS MULTILAYER PCB, SEE STACK-UP DIAGRAM.
- TRACE WIDTH & GAP PARAMETERS ARE SHOWN FOR FR4 IT-180A WITH COMBINED DIELECTRIC THICKNESS .043"; FOR OTHER MATERIALS TRACE WIDTH AND GAP MAY NEED TO BE MODIFIED.
- COPPER LAYERS 3,4 OF THE PCB IS CONTINUOUS GROUND PLANES.

DENOTES PCB COPPER LAYOUT WITH SMOBC (SOLDER MASK OVER BARE COPPER).  
 DENOTES COPPER LAND PATTERN FREE OF SOLDER MASK.

UNLESS OTHERWISE SPECIFIED	INITIALS	DATE
DIMENSIONS ARE IN INCHES	DRAWN ITG	12/17/26
TOLERANCES ON:	CHECKED NP	12/17/26
2 PL DECIMALS ±	APPROVED IL	12/17/26
3 PL DECIMALS ± .005		
ANGLES ± 1°		
FRACTIONS ±		

**Mini-Circuits®** 13 Neptune Avenue  
Brooklyn NY 11235

**PL, GE0805C-20, TB-BFCG-362C+**

OR	ECO-028525	NEW RELEASE	12/18/26	ITG	IL
REV	ECN No.	DESCRIPTION	DATE	DR	AUTH
REVISIONS					

Mini-Circuits®  
THIS DOCUMENT AND ITS CONTENTS ARE THE PROPERTY OF MINI-CIRCUITS. EXCEPT FOR USE EXPRESSLY GRANTED, IN WRITING, TO ITS VENDORS, VENDEE AND THE UNITED STATES GOVERNMENT, MINI-CIRCUITS RESERVES ALL PROPRIETARY DESIGN, USE, MANUFACTURING AND REPRODUCTION RIGHTS THERETO. THESE CONTENTS SHALL NOT BE USED, DUPLICATED OR DISCLOSED TO ANY OUTSIDE PARTY, IN WHOLE OR IN PART, WITHOUT WRITTEN PERMISSION OF MINI-CIRCUITS.  
BSHEETA1.DWG REV:A DATE:01/12/94

SIZE B	CODE IDENT 15542	DRAWING NO: 98-PL-853	REV: OR
FILE: 98PL853	SCALE: 20:1	SHEET: 1 OF 1	

**THIRD ANGLE PROJECTION**

