



COAXIAL

Adapter

SM-BM50+

50Ω DC to 2 GHz SMA-Male to BNC-Male

FEATURES

- Flat Response
- Excellent VSWR
- Low cost adapters, available from stock
- Brass body, nickel plated



Generic photo used for illustration purposes only

Model No.	SM-BM50+
Case Style	DJ1022
Connectors	SMA-Male to BNC-Male

+RoHS Compliant

The +Suffix identifies RoHS Compliance. See our website for methodologies and qualifications

APPLICATIONS

- Interconnection of RF cables and equipment
- Testing

ELECTRICAL SPECIFICATIONS $T_{AMB}=25^{\circ}C$

Parameter	Frequency (GHz)	Min.	Typ.	Max.	Units
Frequency Range	-	DC		2	GHz
Insertion Loss	DC - 2	-	.05	-	dB
VSWR	DC - 2	-	-	1.20	:1

ABSOLUTE MAXIMUM RATINGS

Parameter	Ratings
Operating Temperature	-55°C to +100°C
Storage Temperature	-55°C to +100°C

Permanent damage may occur if any of these limits are exceeded.

REV. D
ECO-016727
SM-BM50+
MCL NY
230202





COAXIAL

Adapter

SM-BM50+

Mini-Circuits

50Ω DC to 2 GHz SMA-Male to BNC-Male

OUTLINE DRAWING

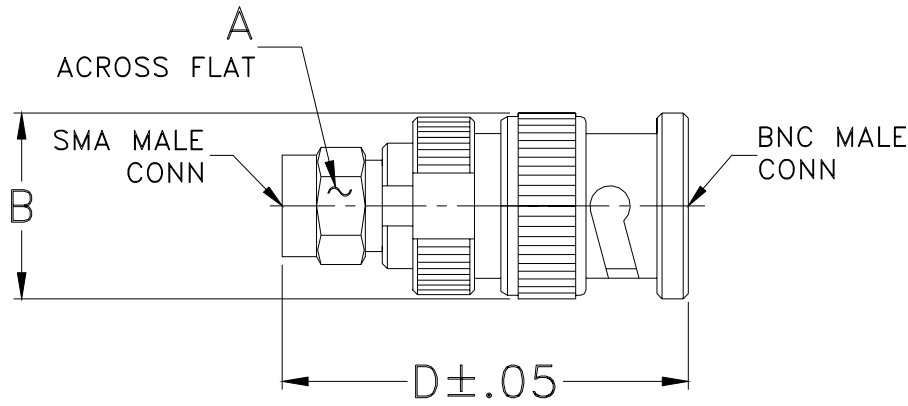

OUTLINE DIMENSIONS (Inch/mm)

A	B	C	D	E	wt
.312	.57	--	1.25	--	grams
7.92	14.48	--	31.75	--	15.0



COAXIAL

Adapter

SM-BM50+

Mini-Circuits

50Ω DC to 2 GHz SMA-Male to BNC-Male

TYPICAL PERFORMANCE DATA

Frequency (MHz)	Insertion Loss (dB)	VSWR (:1)	
		SMA-Male	BNC-Male
10.00	0.00	1.00	1.00
20.00	0.00	1.00	1.00
40.00	0.01	1.01	1.00
50.00	0.01	1.01	1.00
60.00	0.01	1.01	1.01
70.00	0.01	1.01	1.01
80.00	0.01	1.01	1.01
90.00	0.01	1.01	1.01
100.00	0.01	1.01	1.01
200.00	0.01	1.02	1.01
400.00	0.02	1.03	1.01
600.00	0.03	1.03	1.01
800.00	0.04	1.04	1.01
1000.00	0.04	1.05	1.00
1200.00	0.04	1.06	1.01
1400.00	0.04	1.08	1.01
1600.00	0.05	1.10	1.02
1800.00	0.04	1.11	1.02
2000.00	0.05	1.12	1.03

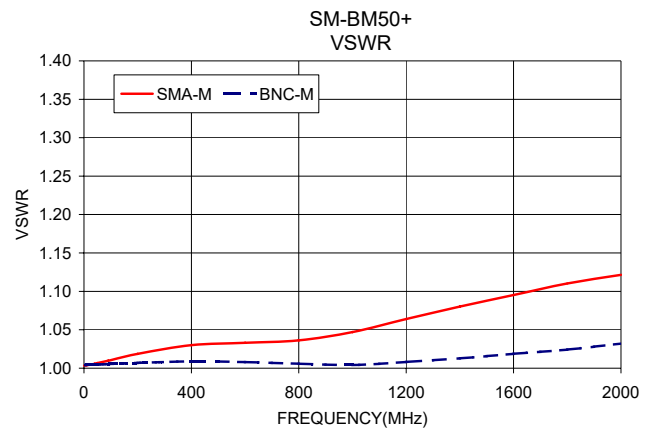
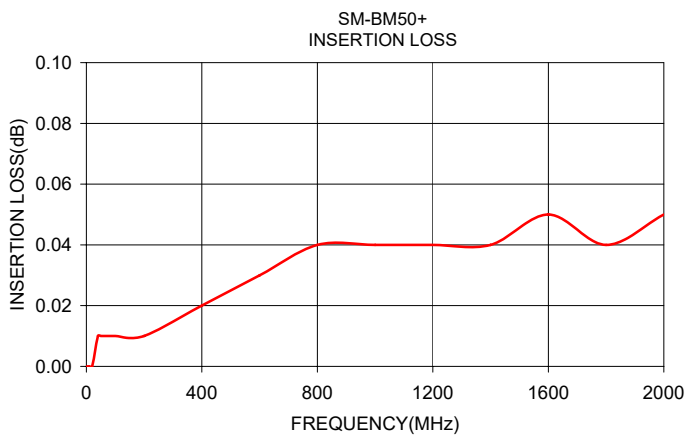

NOTES

- A. Performance and quality attributes and conditions not expressly stated in this specification document are intended to be excluded and do not form a part of this specification document.
- B. Electrical specifications and performance data contained in this specification document are based on Mini-Circuit's applicable established test performance criteria and measurement instructions.
- C. The parts covered by this specification document are subject to Mini-Circuits standard limited warranty and terms and conditions (collectively, "Standard Terms"); Purchasers of this part are entitled to the rights and benefits contained therein. For a full statement of the standard terms and the exclusive rights and remedies thereunder, please visit Mini-Circuits' website at www.minicircuits.com/terms/viewterm.html

