

# Coaxial Switch

## ZFSW-2-46

50Ω SPDT, Reflective DC<sup>5</sup> to 4.6 GHz



Generic photo used for illustration purposes only

CASE STYLE: G144

| Connectors | Model     |
|------------|-----------|
| SMA        | ZFSW-2-46 |

### Maximum Ratings

|                       |                |
|-----------------------|----------------|
| Operating Temperature | -55°C to 100°C |
| Storage Temperature   | -55°C to 150°C |
| Input Power           | see Note 1     |
| Control V             | see Note 2     |

Permanent damage may occur if any of these limits are exceeded.

### Coaxial Connections

|           |   |
|-----------|---|
| RF IN     | s |
| RF OUT 1  | 3 |
| RF OUT 2  | 2 |
| CONTROL 1 | 4 |
| CONTROL 2 | 1 |

### Outline Drawing

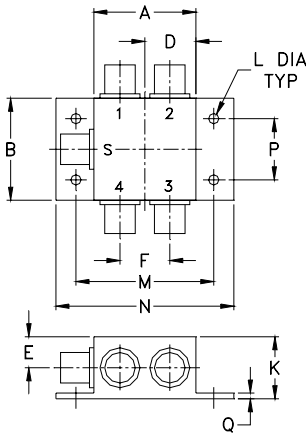

### Outline Dimensions (inch/mm)

|       |       |      |       |       |       |      |       |
|-------|-------|------|-------|-------|-------|------|-------|
| A     | B     | C    | D     | E     | F     | G    | H     |
| 1.25  | 1.25  | --   | .63   | .38   | .61   | --   | --    |
| 31.75 | 31.75 | --   | 16.00 | 9.65  | 15.49 | --   | --    |
| J     | K     | L    | M     | N     | P     | Q    | wt    |
| --    | .76   | .125 | 1.688 | 2.18  | .75   | .07  | grams |
| --    | 19.30 | 3.18 | 42.88 | 55.37 | 19.05 | 1.78 | 85.0  |

### Features

- wideband, DC to 4.6 GHz
- high isolation, 50 dB typ.
- excellent VSWR, 1.3:1 typ

### Applications

- instrumentation
- communication systems
- laboratory

### Electrical Specifications

| FREQ. <sup>5</sup><br>(GHz) | INSERTION LOSS<br>(dB) |      |                 |      |                  |      | 1dB COMPR.<br>(dBm) |                 |                  | IN-OUT ISOLATION<br>(dB) |      |                 |      |                  |      |      |
|-----------------------------|------------------------|------|-----------------|------|------------------|------|---------------------|-----------------|------------------|--------------------------|------|-----------------|------|------------------|------|------|
|                             | DC-200<br>MHz          |      | 200-1000<br>MHz |      | 1000-4600<br>MHz |      | DC-200<br>MHz       | 200-1000<br>MHz | 1000-4600<br>MHz | DC-200<br>MHz            |      | 200-1000<br>MHz |      | 1000-4600<br>MHz |      |      |
| f <sub>L</sub>              | f <sub>U</sub>         | Typ. | Max.            | Typ. | Max.             | Typ. | Max.                | Typ.            | Typ.             | Typ.                     | Typ. | Min.            | Typ. | Min.             | Typ. | Min. |
| DC                          | 4.6                    | 0.9  | 1.1             | 1.0  | 1.3              | 1.3  | 1.8*                | 10              | 17               | 27                       | 60   | 50              | 50   | 40               | 40   | 28   |

\*1.8 dB max up to 3 GHz, 2.8 dB max 3-4.6 GHz

### Additional Specifications

|                                                        |                 |
|--------------------------------------------------------|-----------------|
| Control Voltage, volts                                 |                 |
| Low State                                              | -0.2 to 0       |
| High State (negative)                                  |                 |
| for compression specs                                  | -8              |
| for other specs                                        | -5 to -8        |
| Control Current, mA                                    | 2.5 typ. at -8V |
| VSWR(:1)                                               | 1.3 typ.        |
| Rise/Fall time (10%-90%), ns                           | 2 typ.          |
| Switching time, 50% of Control to 90% RF (Turn-on), ns | 4 typ.          |
| 10% RF (Turn-off), ns                                  | 2.5 typ.        |
| Video Leakage, mVp-p 0/-5V Control                     | 30 typ.         |

1. Max Input RF power, +30 dBm except 100-500 MHz +27 dBm, and DC-100 MHz +24 dBm
2. Control voltage (-10V) maximum.
3. Video leakage or break through is defined as leakage of switching signal to RF output ports.
4. OFF state at RF output is low impedance.
5. All RF connections must be DC blocked or held at 0V DC.

### CONTROL LOGIC

| Control Ports |    | RF outputs |     |
|---------------|----|------------|-----|
| 1             | 2  | 1          | 2   |
| -V            | 0  | On         | Off |
| 0             | -V | Off        | On  |

### Electrical Schematic

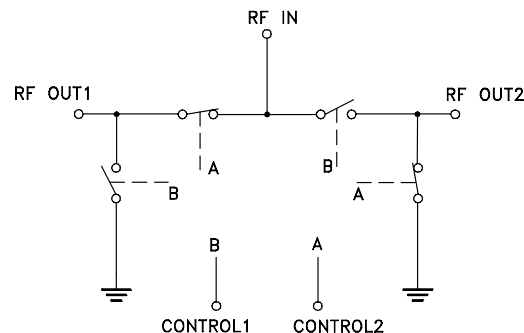

### Notes

- Performance and quality attributes and conditions not expressly stated in this specification document are intended to be excluded and do not form a part of this specification document.
- Electrical specifications and performance data contained in this specification document are based on Mini-Circuit's applicable established test performance criteria and measurement instructions.
- The parts covered by this specification document are subject to Mini-Circuits standard limited warranty and terms and conditions (collectively, "Standard Terms"); Purchasers of this part are entitled to the rights and benefits contained therein. For a full statement of the Standard Terms and the exclusive rights and remedies thereunder, please visit Mini-Circuits' website at [www.minicircuits.com/MCLStore/terms.jsp](http://www.minicircuits.com/MCLStore/terms.jsp)



## Typical Performance Data

| FREQ.<br>(MHz) | ON INSERTION LOSS (dB)<br>CONTROL @ 0V/-5V<br>IN-OUT |          | OFF ISOLATION (dB)<br>CONTROL @ 0V/-5V<br>IN-OUT |          | VSWR<br>IN | VSWR<br>ON | VSWR<br>OUT<br>OFF |
|----------------|------------------------------------------------------|----------|--------------------------------------------------|----------|------------|------------|--------------------|
|                | $\bar{x}$                                            | $\sigma$ | $\bar{x}$                                        | $\sigma$ |            |            |                    |
| 3.00           | 0.54                                                 | 0.04     | 83.44                                            | 4.68     | 1.12       | 1.12       | 16.46              |
| 5.00           | 0.54                                                 | 0.04     | 83.46                                            | 2.97     | 1.12       | 1.12       | 16.21              |
| 10.00          | 0.54                                                 | 0.04     | 81.44                                            | 2.66     | 1.12       | 1.12       | 16.21              |
| 20.00          | 0.61                                                 | 0.06     | 76.29                                            | 2.13     | 1.12       | 1.12       | 16.04              |
| 50.00          | 0.59                                                 | 0.04     | 69.27                                            | 0.92     | 1.12       | 1.12       | 15.37              |
| 100.00         | 0.62                                                 | 0.04     | 66.59                                            | 1.42     | 1.12       | 1.12       | 14.63              |
| 200.00         | 0.65                                                 | 0.04     | 61.43                                            | 0.74     | 1.12       | 1.12       | 14.00              |
| 500.00         | 0.70                                                 | 0.04     | 53.61                                            | 0.93     | 1.13       | 1.13       | 12.83              |
| 911.55         | 0.75                                                 | 0.04     | 47.64                                            | 0.59     | 1.14       | 1.15       | 11.86              |
| 1000.00        | 0.76                                                 | 0.04     | 46.91                                            | 0.61     | 1.14       | 1.16       | 11.79              |
| 1581.00        | 0.92                                                 | 0.05     | 41.27                                            | 0.47     | 1.22       | 1.20       | 11.85              |
| 2107.00        | 0.92                                                 | 0.06     | 37.77                                            | 0.41     | 1.36       | 1.21       | 11.91              |
| 2370.00        | 0.88                                                 | 0.06     | 37.33                                            | 0.42     | 1.37       | 1.26       | 9.64               |
| 2489.55        | 1.01                                                 | 0.07     | 36.86                                            | 0.43     | 1.41       | 1.34       | 9.98               |
| 2752.55        | 1.17                                                 | 0.09     | 35.65                                            | 0.39     | 1.51       | 1.42       | 9.70               |
| 3278.55        | 1.15                                                 | 0.11     | 33.10                                            | 0.42     | 1.53       | 1.39       | 13.14              |
| 3804.55        | 1.16                                                 | 0.08     | 33.46                                            | 0.37     | 1.50       | 1.35       | 13.37              |
| 4330.55        | 0.87                                                 | 0.05     | 31.99                                            | 0.42     | 1.31       | 1.24       | 15.41              |
| 4474.00        | 0.70                                                 | 0.04     | 32.16                                            | 0.40     | 1.23       | 1.23       | 17.84              |
| 4600.00        | 1.08                                                 | 0.04     | 32.78                                            | 0.42     | 1.13       | 1.16       | 14.40              |

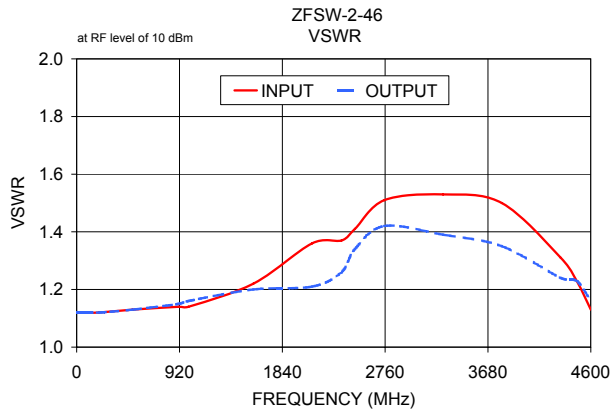
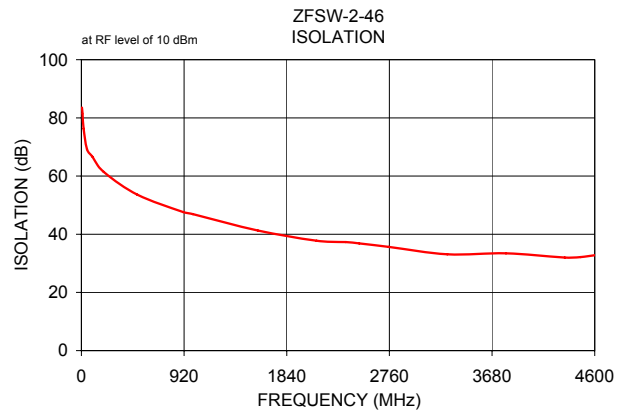
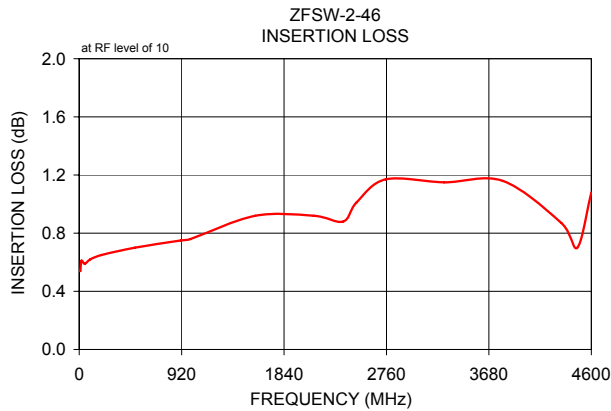

**Notes**

- A. Performance and quality attributes and conditions not expressly stated in this specification document are intended to be excluded and do not form a part of this specification document.
- B. Electrical specifications and performance data contained in this specification document are based on Mini-Circuit's applicable established test performance criteria and measurement instructions.
- C. The parts covered by this specification document are subject to Mini-Circuits standard limited warranty and terms and conditions (collectively, "Standard Terms"); Purchasers of this part are entitled to the rights and benefits contained therein. For a full statement of the Standard Terms and the exclusive rights and remedies thereunder, please visit Mini-Circuits' website at [www.minicircuits.com/MCLStore/terms.jsp](http://www.minicircuits.com/MCLStore/terms.jsp)

