



CAVITY COAXIAL

Bandpass Filter

ZVBP-4700-S+

Mini-Circuits

50Ω 4200 to 5200 MHz SMA Female

KEY FEATURES

- Low Insertion Loss, 0.4 dB Typ.
- Good Return Loss, 19 dB Typ.
- High Rejection, 80 dB Typ.
- Wide Stopband up to 16000 MHz
- Power Handling 10 Watts

APPLICATIONS

- Radar

PRODUCT OVERVIEW

Mini-Circuits' ZVBP-4700-S+ is a coaxial cavity filter designed by implementing resonant structures with very high Q and are ideal for narrow-band, high-selectivity applications. Mini-Circuits' coaxial cavity filters feature a special protective assembly to prevent accidental de-tuning that would otherwise require expensive replacement or return to factory for re-tuning. Precise machining allows realization of cavity filters with small form factors for applications where size is critical.

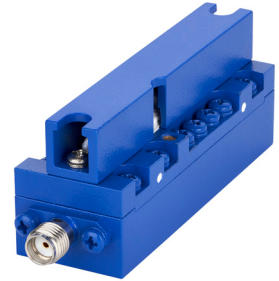

Generic photo used for illustration purposes only

FUNCTIONAL DIAGRAM

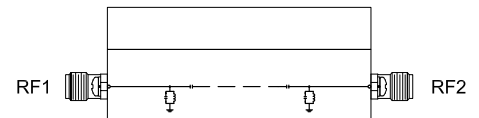

ELECTRICAL SPECIFICATIONS¹ AT +25°C

Parameter		F#	Frequency (MHz)	Min.	Typ.	Max.	Units
Passband	Center Frequency	—	—	—	4700	—	MHz
	Insertion Loss	F1-F2	4200 - 5200	—	0.4	0.8	dB
	Return Loss	F1-F2	4200 - 5200	14	19	—	dB
Stop Band, Lower	Rejection	DC-F3	DC - 2700	70	80	—	dB
		F3-F4	2700 - 3600	40	50	—	dB
Stop Band, Upper	Rejection	F5-F6	5650 - 6100	40	50	—	dB
		F6-F7	6100 - 16000	70	80	—	dB

1. This filter is bi-directional RF1 and RF2 ports may be interchanged, see S-Parameters for actual performance.

ABSOLUTE MAXIMUM RATINGS^{2,3}

Parameter	Ratings
Operating Temperature	-40°C to +85°C
Storage Temperature	-55°C to +100°C
Input Power ⁴	10W at +25°C

2. Permanent damage may occur if any of these limits are exceeded.
 3. Input and output ports are DC short to ground.
 4. Power rating applies only to signals within the passband.

TYPICAL FREQUENCY RESPONSE AT +25°C

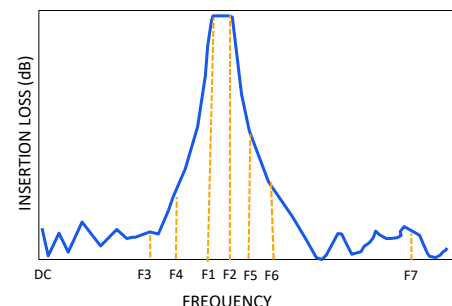



CAVITY COAXIAL

Bandpass Filter

ZVBP-4700-S+

Mini-Circuits

50Ω 4200 to 5200 MHz SMA Female

TYPICAL PERFORMANCE GRAPHS

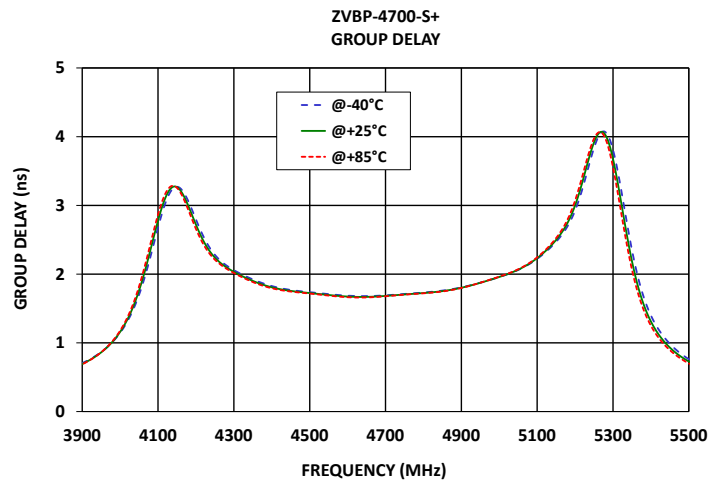
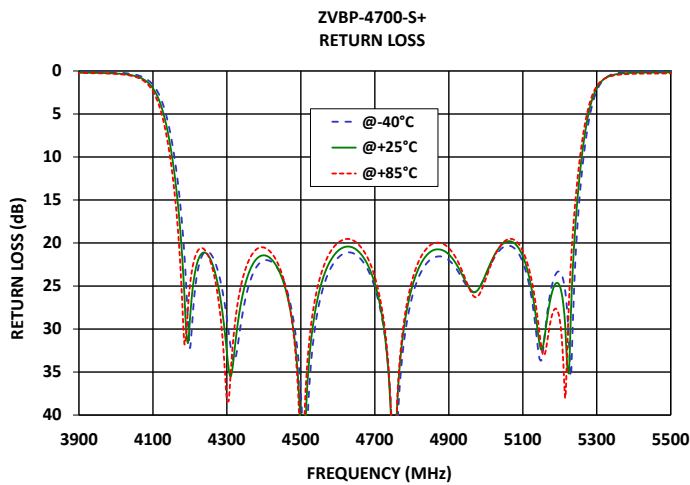
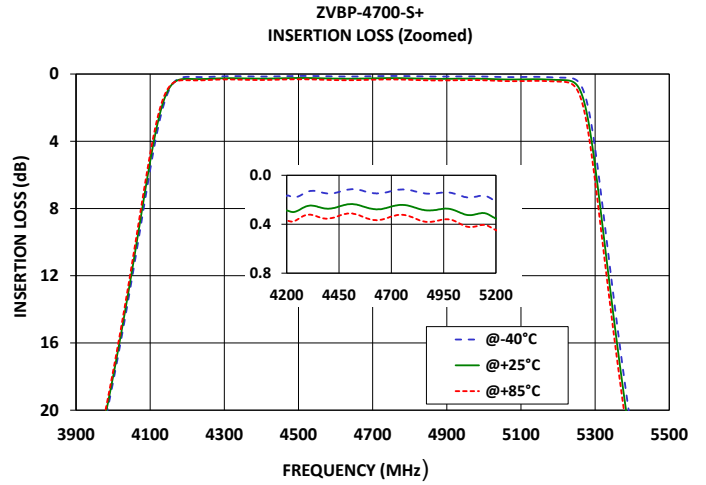
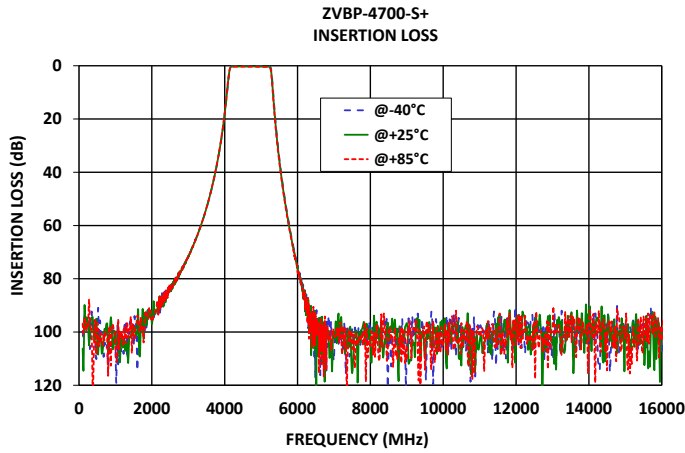



CAVITY COAXIAL

Bandpass Filter

ZVBP-4700-S+

Mini-Circuits

50Ω 4200 to 5200 MHz SMA Female

CONNECTOR DESCRIPTION

Function	Marking on Unit	Connector
RF1 ¹	1	SMA Female
RF2 ¹	2	SMA Female

CASE STYLE DRAWING

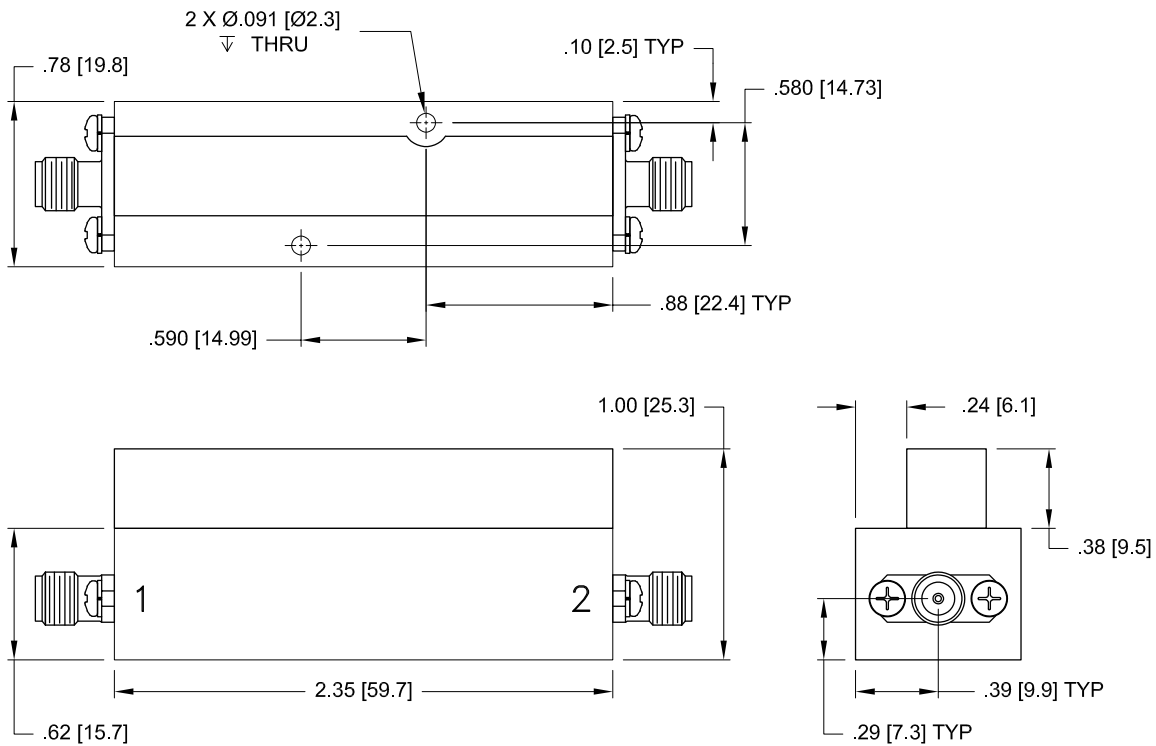

Unit Weight: 58 Grams.

Dimensions are in inches (mm). Tolerances: 2 Pl. ± .100; 3 Pl. ± .015

PRODUCT MARKING*: ZVBP-4700-S+

*Marking may contain other features or characters for internal lot control.





CAVITY COAXIAL

Bandpass Filter

ZVBP-4700-S+

Mini-Circuits

50Ω 4200 to 5200 MHz SMA Female

ADDITIONAL INFORMATION IS AVAILABLE ON OUR DASHBOARD

[CLICK HERE](#)

Performance Data & Graphs	Data Graphs S-Parameter (S2P Files) Data Set (.zip file)
Case Style	AAJ3617
RoHS Status	Compliant
Environmental Ratings	ENV46

NOTES

- A. Performance and quality attributes and conditions not expressly stated in this specification document are intended to be excluded and do not form a part of this specification document.
- B. Electrical specifications and performance data contained in this specification document are based on Mini-Circuits' applicable established test performance criteria and measurement instructions.
- C. The parts covered by this specification document are subject to Mini-Circuits' standard limited warranty and terms and conditions (collectively, "Standard Terms"); Purchasers of this part are entitled to the rights and benefits contained therein. For a full statement of the standard terms and the exclusive rights and remedies thereunder, please visit Mini-Circuits' website at www.minicircuits.com/terms/viewterm.html

