

Outline Dimensions

LL2145

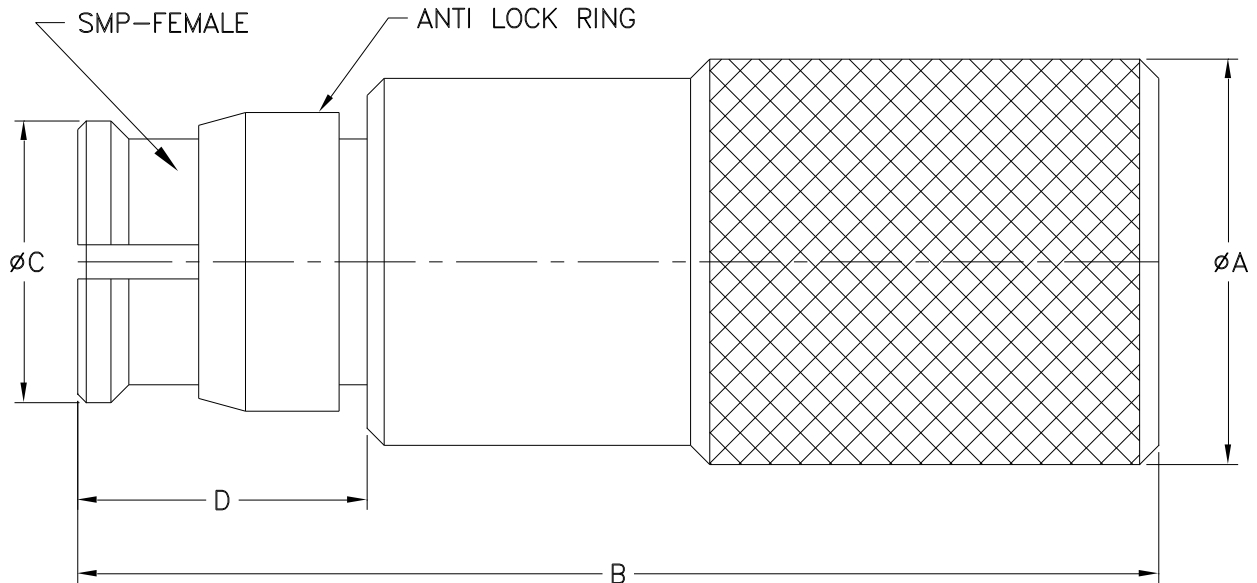

CASE #	A	B	C	D	E	WT. GRAM
LL2145	.189 (4.8)	.500 (12.7)	.130 (3.3)	.134 (3.4)	- -	0.8

Dimensions are in inches (mm). Tolerances: 2Pl. $\pm .030$; 3Pl. $\pm .015$

Notes:

1. Case material: Beryllium Copper.
2. Finish: Gold plating.



P.O. Box 350166, Brooklyn, New York 11235-0003 (718) 934-4500 Fax (718) 332-4661 For detailed performance specs & shopping online see Mini-Circuits web site



The Design Engineers Search Engine Provides ACTUAL Data Instantly From MINI-CIRCUITS At: www.minicircuits.com

RF/IF MICROWAVE COMPONENTS