

## Outline Dimensions

QB2223

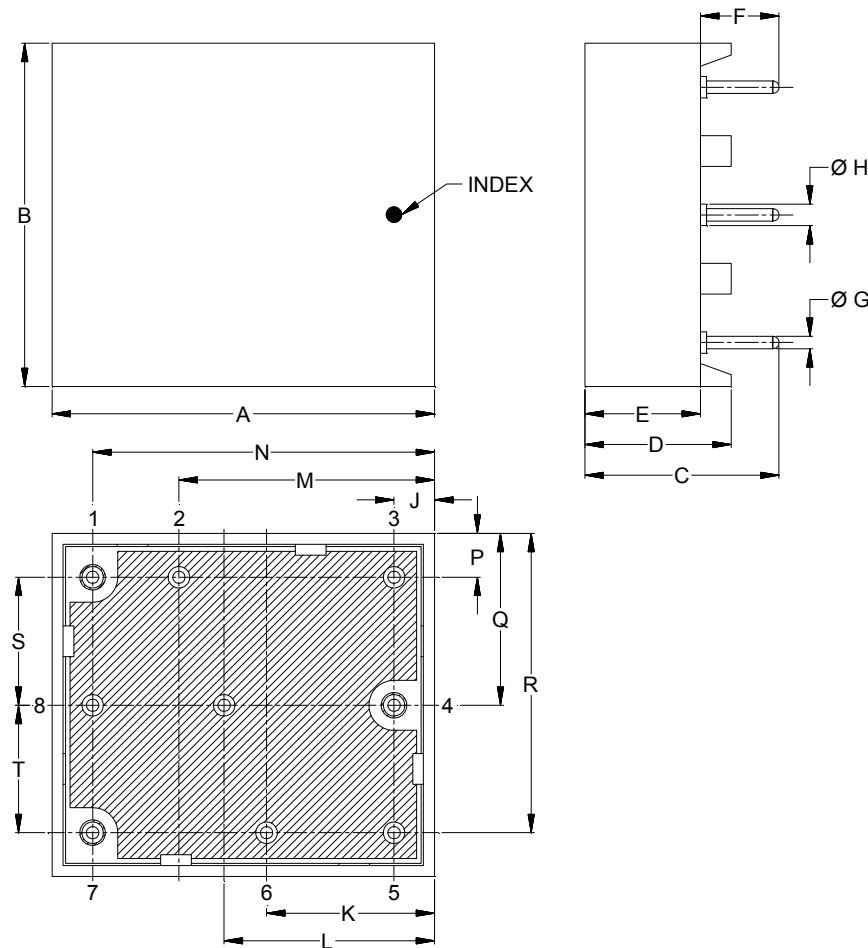

CASE#	A	B	C	D	E	F	G	H	J	K
QB2223	1.243 (31.56)	1.117 (28.36)	.630 (16.00)	.475 (12.07)	.375 (9.53)	.255 (6.48)	.040 (1.02)	.070 (1.78)	.132 (3.35)	.546 (13.87)

CASE#	L	M	N	P	Q	R	S	T	WT.GRAMS
QB2223	.684 (17.37)	.831 (21.10)	1.111 (28.22)	.143 (3.63)	.559 (14.21)	.974 (24.74)	.417 (10.58)	.415 (10.53)	7

Dimensions are in inches (mm). Tolerances: 2 Pl.  $\pm .015$ ; 3 Pl.  $\pm .030$

### Notes:

1. Cover material: Fortan PPS
2. Pin material: Brass alloy [C3604]
3. Pin finish: Gold flash
4. Tolerance on pin diameter  $\pm .001$
5. Base: Printed wiring laminate.

**Mini-Circuits®**  
ISO 9001 ISO 14001 CERTIFIED

ALL NEW  
minicircuits.com

P.O. Box 350166, Brooklyn, New York 11235-0003 (718) 934-4500 Fax (718) 332-4661 For detailed performance specs & shopping online see Mini-Circuits web site



The Design Engineers Search Engine Provides ACTUAL Data Instantly From MINI-CIRCUITS At: [www.minicircuits.com](http://www.minicircuits.com)

RF/IF MICROWAVE COMPONENTS