

# Case Style

# UU

## Outline Dimensions

### UU2413-4

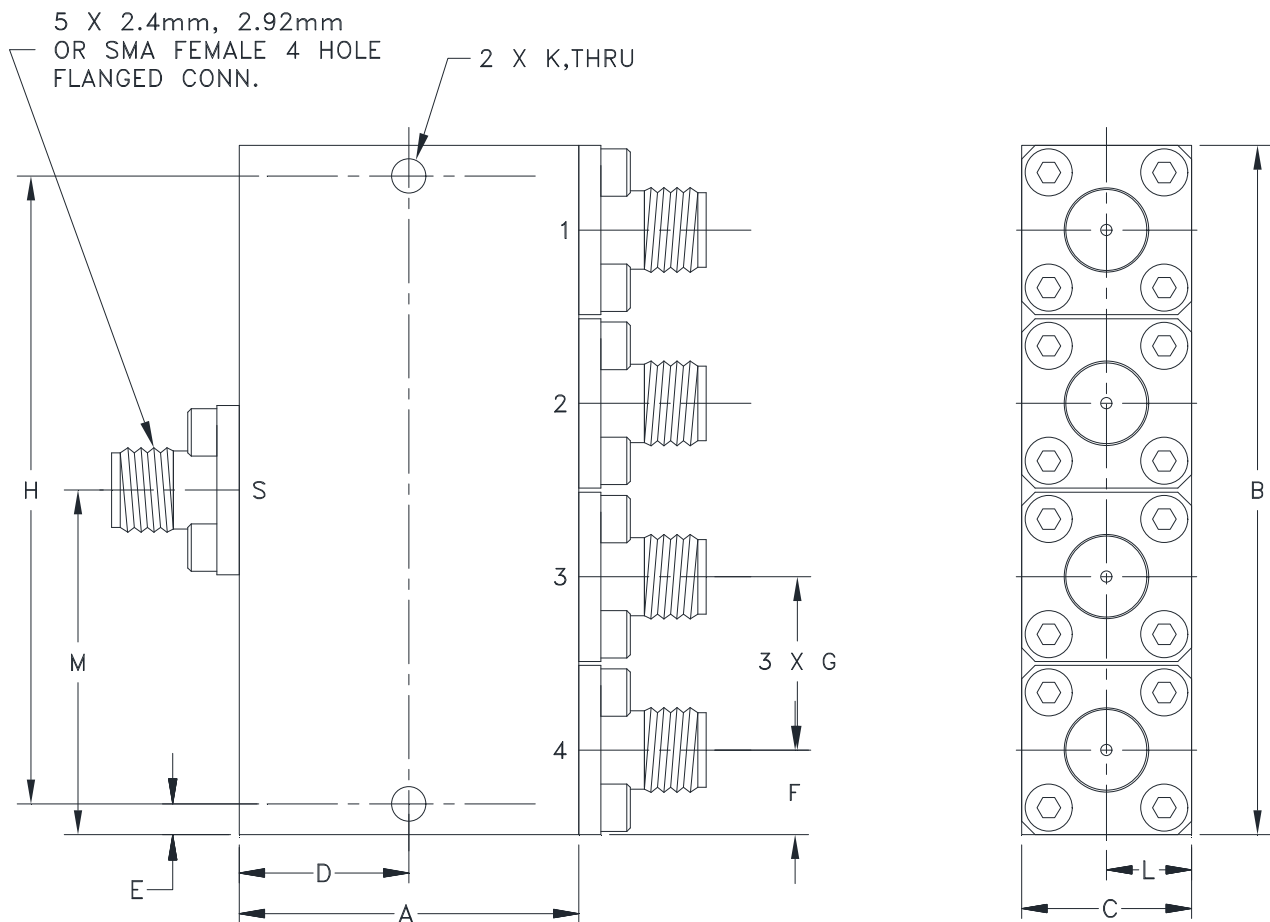

| CASE#    | A               | B               | C              | D               | E               | F             | G             | H                | J  | K              | L             | M               |
|----------|-----------------|-----------------|----------------|-----------------|-----------------|---------------|---------------|------------------|----|----------------|---------------|-----------------|
| UU2413-4 | 1.00<br>(25.40) | 2.04<br>(51.70) | .50<br>(12.70) | .500<br>(12.70) | 0.091<br>(2.30) | .25<br>(6.35) | .51<br>(13.0) | 1.854<br>(47.10) | -- | .100<br>(2.60) | .25<br>(6.35) | 1.02<br>(25.85) |

| CASE#    | WT. GRAMS |
|----------|-----------|
| UU2413-4 | 70        |

Dimensions are in inches (mm). Tolerances: 2 Pl.  $\pm .03$ ; 3 Pl.  $\pm .015$

### Notes:

1. Case material: Aluminum alloy.
2. Case finish: Painting Color: Blue.
3. Refer to the individual model data sheet for the type of connectors available.

**Mini-Circuits®**  
ISO 9001 ISO 14001 CERTIFIED

ALL NEW  
minicircuits.com

P.O. Box 350166, Brooklyn, New York 11235-0003 (718) 934-4500 Fax (718) 332-4661 For detailed performance specs & shopping online see Mini-Circuits web site



The Design Engineers Search Engine Provides ACTUAL Data Instantly From MINI-CIRCUITS At: [www.minicircuits.com](http://www.minicircuits.com)

RF/MICROWAVE COMPONENTS