

Outline Dimensions

WH3317

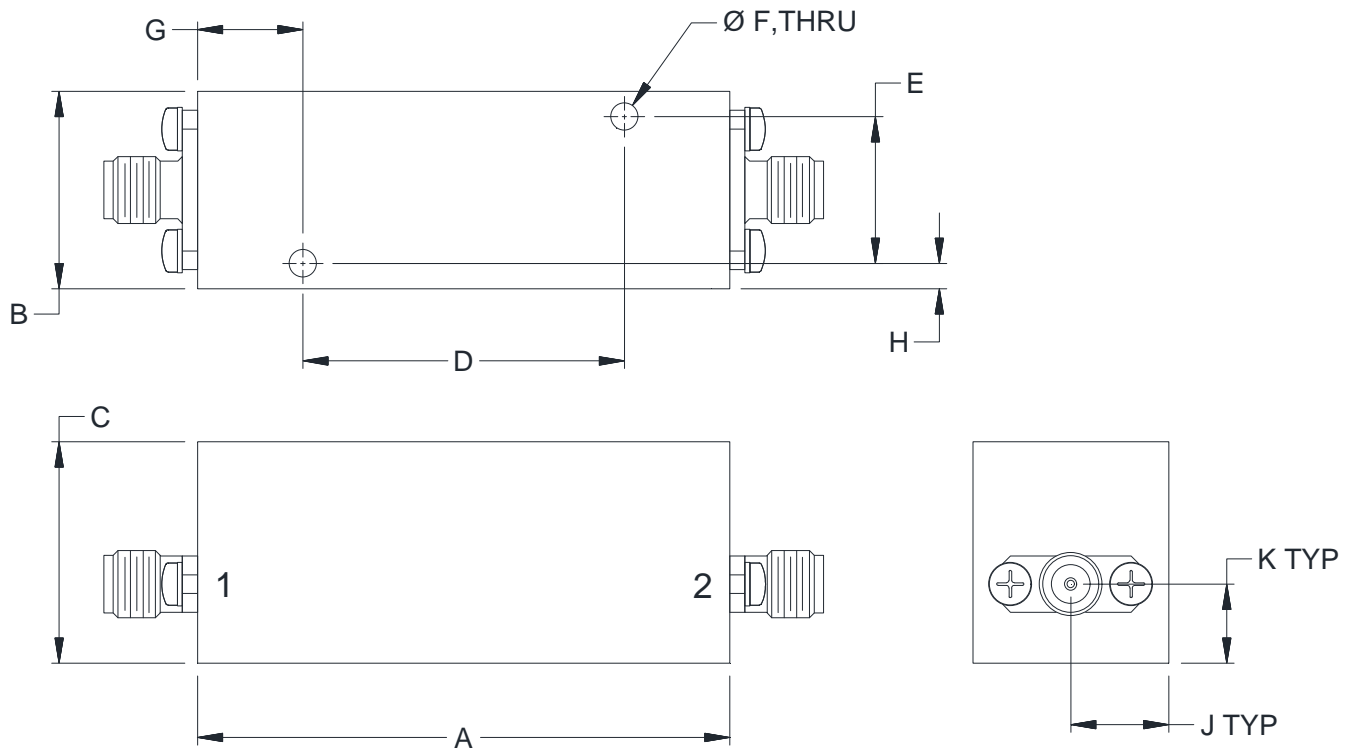

CASE#	A	B	C	D	E	F
WH3317	2.12 (53.8)	.78 (19.8)	.87 (22.2)	1.280 (32.51)	.580 (14.73)	.110 (2.79)

CASE#	G	H	J	K	WT. GRAMS
WH3317	.42 (10.7)	.10 (2.5)	.39 (9.9)	.31 (7.9)	62

Dimensions are in inches (mm). Tolerances: 2 Pl. $\pm .100$; 3 Pl. $\pm .015$

Notes:

1. Case material: Aluminum.
2. Case Finish: Powder coated.
3. Refer to the individual model data sheet for the type of connectors available.



P.O. Box 350166, Brooklyn, New York 11235-0003 (718) 934-4500 Fax (718) 332-4661 For detailed performance specs & shopping online see Mini-Circuits web site



The Design Engineers Search Engine Provides ACTUAL Data Instantly From MINI-CIRCUITS At: www.minicircuits.com

RF/IF MICROWAVE COMPONENTS