

## Outline Dimensions

WY3407

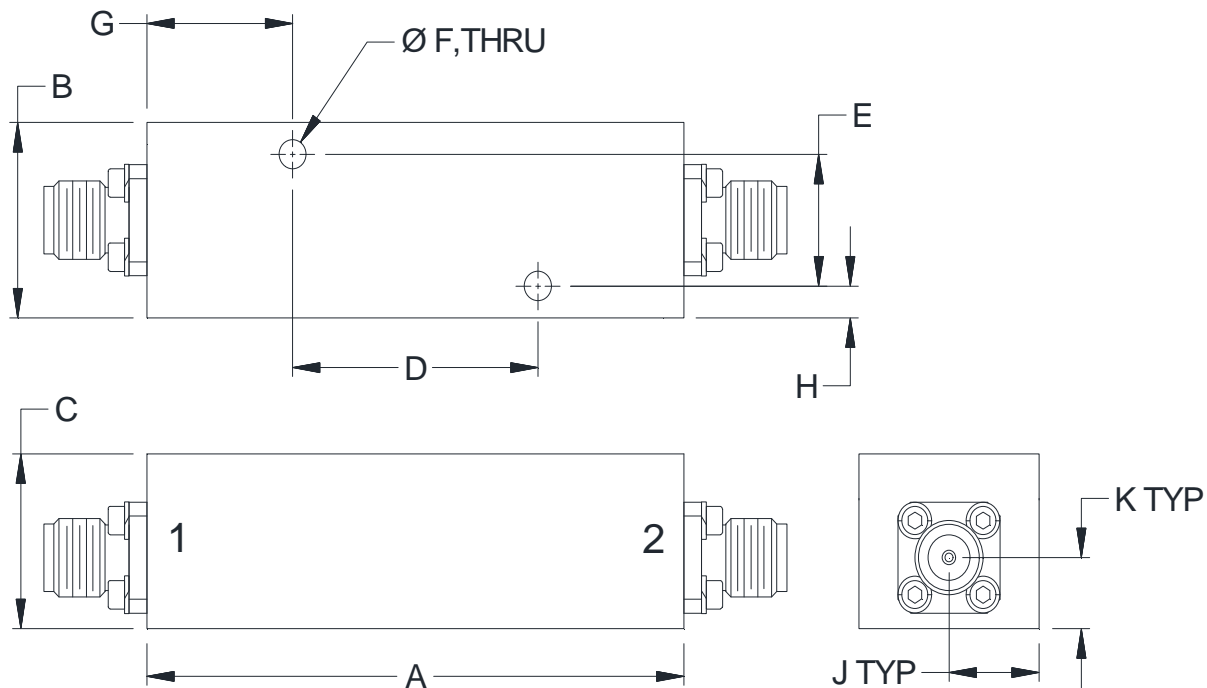

CASE#	A	B	C	D	E	F
WY3407	1.97 (50.0)	.66 (16.8)	.59 (15.0)	.900 (22.86)	.445 (11.30)	.100 (2.54)

CASE#	G	H	J	K	WT. GRAMS
WY3407	.54 (13.6)	.11 (2.7)	.33 (8.4)	.24 (6.1)	72

Dimensions are in inches (mm). Tolerances: 2 Pl.  $\pm .100$ ; 3 Pl.  $\pm .015$

### Notes:

1. Case material: Brass.
2. Case Finish: Powder coated.
3. Refer to the individual model data sheet for the type of connectors available.



P.O. Box 350166, Brooklyn, New York 11235-0003 (718) 934-4500 Fax (718) 332-4661 For detailed performance specs & shopping online see Mini-Circuits web site



Provides ACTUAL Data Instantly From MINI-CIRCUITS At: [www.minicircuits.com](http://www.minicircuits.com)

RF/IF MICROWAVE COMPONENTS